

FOR OFF-ROAD/CLOSED COURSE USE ONLY



DRIVEN SPROCKET COVER FOR HONDA MOTORCYCLES PART# DEC-004

Installation

1. Using an 8mm socket remove the original screws from the OEM cover then rotate and remove cover and carefully remove the metal chain guard from inside the OEM cover.
2. Remove the metal wire guide from motorcycle. (see A.)
3. Reinstall the metal chain guard with the Driven sprocket cover using the supplied spacers and hardware (with blue Loctite) while safely pushing wires out of the path of the drivetrain and behind the metal chain guard. Double check wires to ensure nothing has become pinched during installation. (see B. & C.)

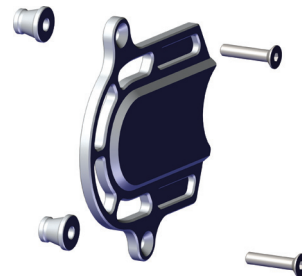

TOOLS REQUIRED

- 8mm socket and wrench
- Blue Loctite
- 4mm hex key

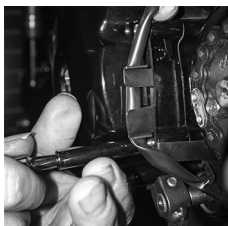

A

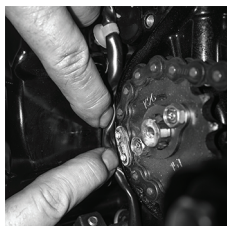

B



C

THIS PRODUCT MUST BE INSTALLED BY A CERTIFIED MOTORCYCLE TECHNICIAN

FOR OFF-ROAD/CLOSED COURSE USE ONLY



DRIVEN SPROCKET COVER FOR HONDA MOTORCYCLES PART# DEC-004

Installation

1. Using an 8mm socket remove the original screws from the OEM cover then rotate and remove cover and carefully remove the metal chain guard from inside the OEM cover.
2. Remove the metal wire guide from motorcycle. (see A.)
3. Reinstall the metal chain guard with the Driven sprocket cover using the supplied spacers and hardware (with blue Loctite) while safely pushing wires out of the path of the drivetrain and behind the metal chain guard. Double check wires to ensure nothing has become pinched during installation. (see B. & C.)

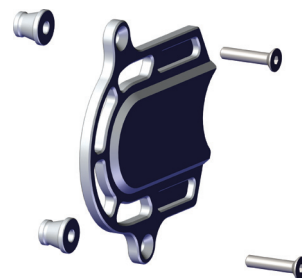

TOOLS REQUIRED

- 8mm socket and wrench
- Blue Loctite
- 4mm hex key

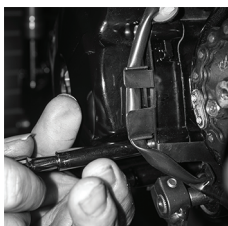

A

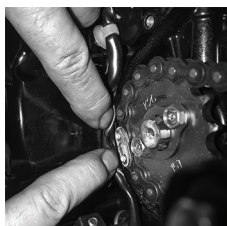

B

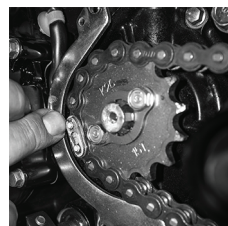

C

THIS PRODUCT MUST BE INSTALLED BY A CERTIFIED MOTORCYCLE TECHNICIAN