

**FOR OFF ROAD/RACE USE ONLY!**



Part#:DHFCB-AP/BM/DU-01/DU-02(DRIVEN HALO FUEL BASE/CAP)

DRIVEN PERFORMANCE PRODUCTS  
WWW.DRIVENRACING.COM  
866-5-DRIVEN

**INSTALLATION INSTRUCTIONS**

NOTE: These instructions apply to DHFCB-AP, DHFCB-BM, DHFCB-DU(01&02)

1. Make sure you have all of the required parts for installation. (see checklist below)
2. Remove stock (OEM) fuel cap.
3. On all bikes listed above you will be re-using the OEM vent system. The Halo Base will only replace the aluminum ring.
4. Separate aluminum ring from plastic vent system/base by removing the bolts.
5. Install OEM gasket and plastic vent system following by the Driven Halo base.
6. Make sure both base and cap gaskets are installed.
7. Install the screws into the fuel cap and tighten to 6 FT/LB. It is highly recommended to use blue Loctite while installing these screws.  
Install the ¼ turn cap by pushing down and turning clockwise until it locks into place. You can release the cap by pushing down and turning it counter-clockwise.

**TOOLS REQUIRED**

- 4mm Hex Key
- 3mm Hex Key (Honda)
- Blue (#242) Loctite

**TORQUE SPECS AND INFO**

- All Hardware: 6FT/LB

**PARTS CHECKLIST**

- Halo Cap
- Halo Base
- O-Ring (installed on Halo cap)
- Gasket (installed on Halo base)
- Hardware (all necessary hardware)

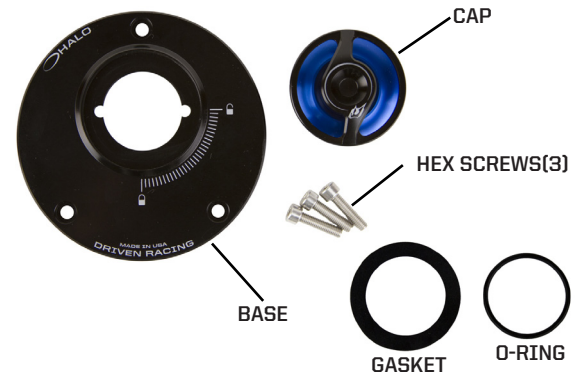

**THIS PRODUCT IS INTENDED TO BE INSTALLED BY A CERTIFIED TECHNICIAN\***

**FOR OFF ROAD/RACE USE ONLY!**



Part#:DHFCB-AP/BM/DU-01/DU-02(DRIVEN HALO FUEL BASE/CAP)

DRIVEN PERFORMANCE PRODUCTS  
WWW.DRIVENRACING.COM  
866-5-DRIVEN

**INSTALLATION INSTRUCTIONS**

NOTE: These instructions apply to DHFCB-AP, DHFCB-BM, DHFCB-DU(01&02)

1. Make sure you have all of the required parts for installation. (see checklist below)
2. Remove stock (OEM) fuel cap.
3. On all bikes listed above you will be re-using the OEM vent system. The Halo Base will only replace the aluminum ring.
4. Separate aluminum ring from plastic vent system/base by removing the bolts
5. Install OEM gasket and plastic vent system following by the Driven Halo base
6. Make sure both base and cap gaskets are installed.
7. Install the screws into the fuel cap and tighten to 6 FT/LB. It is highly recommended to use blue Loctite while installing these screws.  
Install the ¼ turn cap by pushing down and turning clockwise until it locks into place. You can release the cap by pushing down and turning it counter-clockwise.

**TOOLS REQUIRED**

- 4mm Hex Key
- 3mm Hex Key (Honda)
- Blue (#242) Loctite

**TORQUE SPECS AND INFO**

- All Hardware: 6FT/LB

**PARTS CHECKLIST**

- Halo Cap
- Halo Base
- O-Ring (installed on Halo cap)
- Gasket (installed on Halo base)
- Hardware (all necessary hardware)



**THIS PRODUCT IS INTENDED TO BE INSTALLED BY A CERTIFIED TECHNICIAN\***

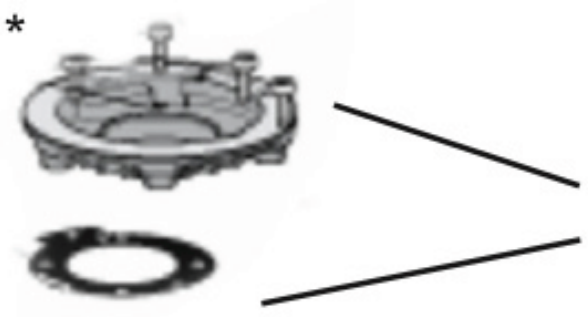

Must be reused with Halo Fuel Cap for Aprilia, Ducati and BMW. Images provided may vary.

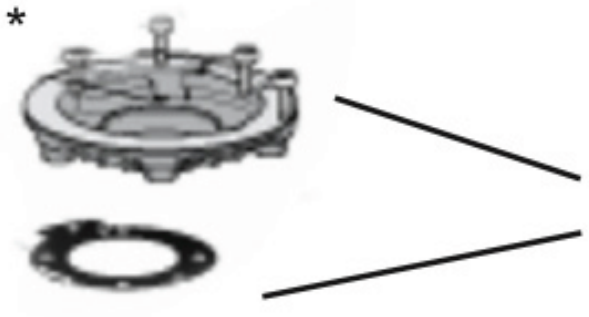
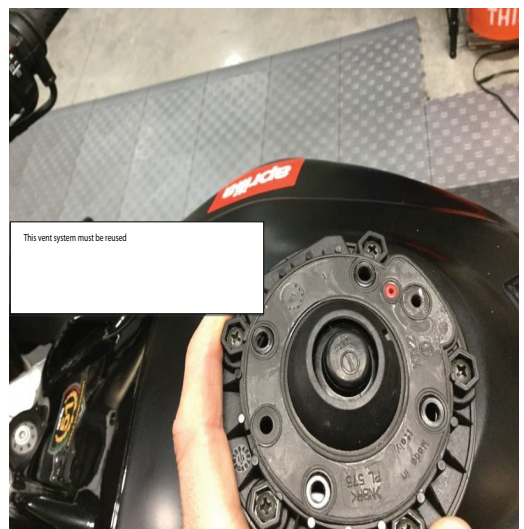
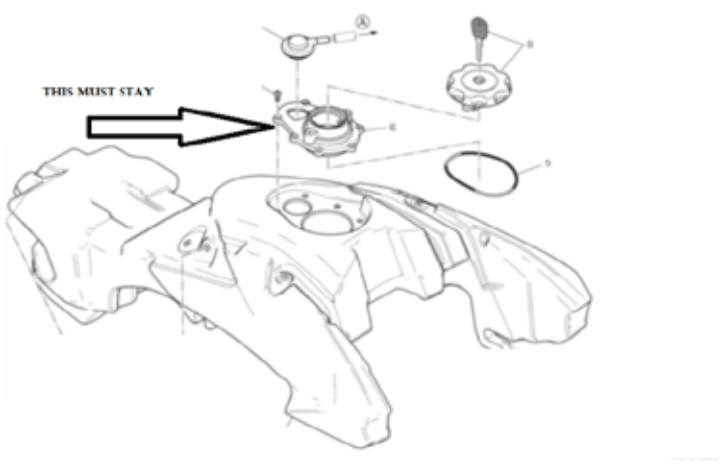

Must be reused with Halo Fuel Cap for Aprilia, Ducati and BMW. Images provided may vary.

