

FOR OFF ROAD/RACE USE ONLY!



Driven Racing 2017 Yamaha FZ-09 Fender Eliminator Kit

Part#: DYF-09/DYF-010

INSTALLATION INSTRUCTIONS

Note: this kit will require you to purchase part number DRAX-121 (SOLD SEPERATLY)

Removal:

1. Place bike on flat surface or a rear stand
2. Remove rear axle nut and pull axle out of the bike discard rear fender arm and right side oem axle block (fig 4)
3. Disconnect wiring from rear fender and loop back into tail section area
4. Remove seat and seat bracket (fig 1)
5. Remove rear side panel assembly. (fig 2)
6. Remove inner fender assembly (fig 3)

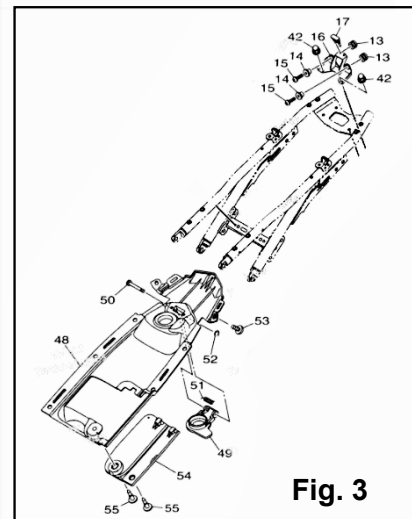
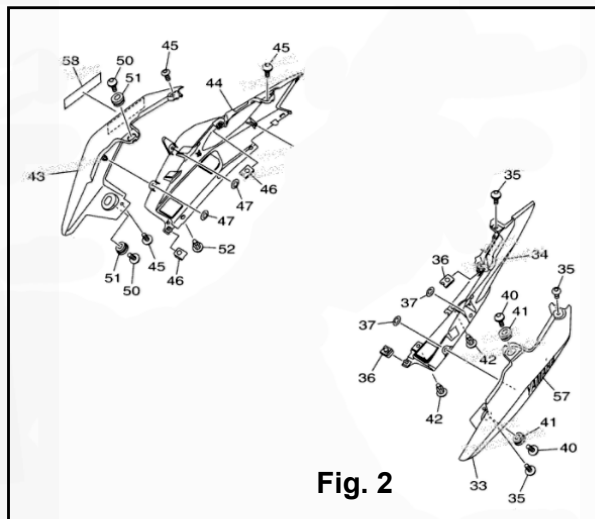
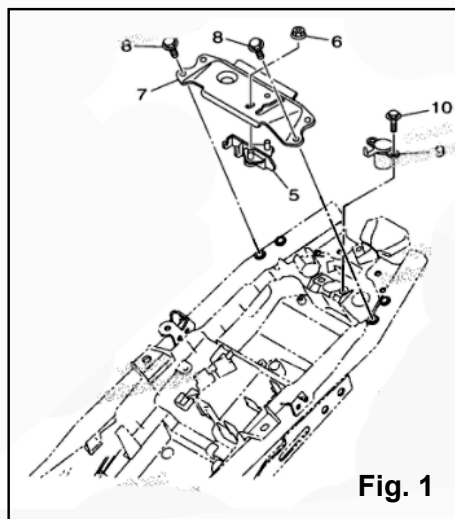
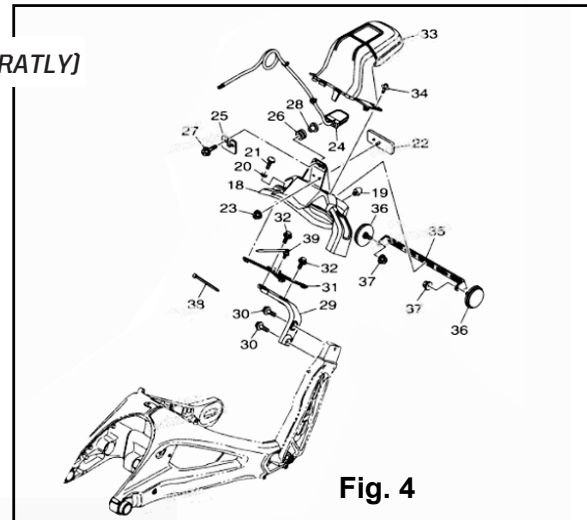

Installation of Axle Blocks

1. Install part number DRAX-121 (SOLD SEPERATLY)
2. Adjust chain as necessary and torque rear axle to factory spec.

Installation of Fender Eliminator Kit

1. Install part number 100550 using supplied bolt and washer
2. Install inner fender assembly (fig 3)
3. Install side panels see (fig 2)
4. Install part number 100551 & 100552 and install license plate.

NOTE: For kit number DYF-010 (with turn signals) see turn signal installation guide in our download section

THIS PRODUCT IS INTENDED TO BE INSTALLED BY A CERTIFIED TECHNICIAN*

