

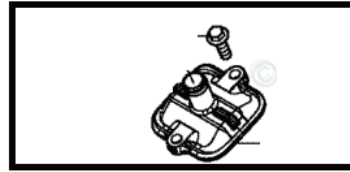

## 16-19 HONDA CRF 1000/20-22 CRF 1100 BLOCKOFF PLATE

1. Remove the hoses from the factory reed cover
2. Remove oem block off cover
3. Install Driven Racing plate using oem screws.
4. Remove hose from air box and plug with supplied rubber plug.
5. Leave pump plugged to electrical harness



**Remove**

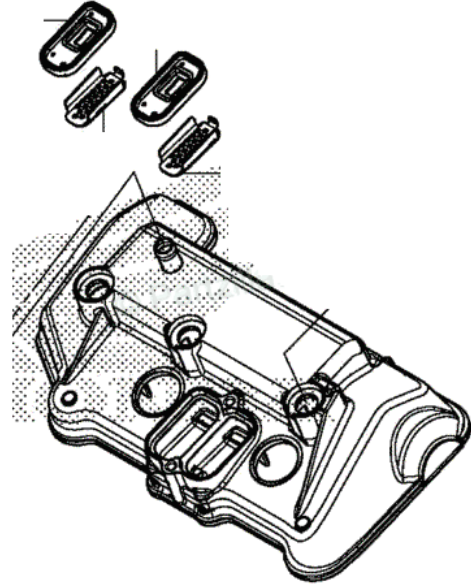
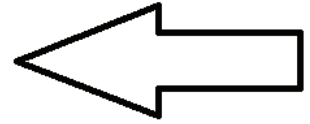

## 16-19 HONDA CRF 1000/20-22 CRF 1100 BLOCKOFF PLATE

1. Remove the hoses from the factory reed cover
2. Remove oem block off cover
3. Install Driven Racing plate using oem screws.
4. Remove hose from air box and plug with supplied rubber plug.
5. Leave pump plugged to electrical harness

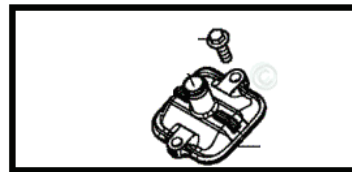

**Remove**

