

FOR OFF ROAD/RACE USE ONLY!



Driven Triumph 765 street triple s/r/rs 17-22

Part #

Installation Instructions

Removal of Left Side

1. Remove shift side heel guard
2. Remove split pin from heim joint and use an 8mm wrench to remove ball from shift lever
3. Remove frame plate from bike
4. Remove exhaust bolt (retains rubber bushing)
5. Remove right side frame plate
6. Remove master cylinder and plunger from bracket.

Tools Required

- 8mm Open End Wrench
- 5mm Hex Key
- 6mm Hex Key
- 8mm Hex Key
- Needle Nose Pliers
- Screw Driver
- Blue Loctite
- Impact Gun

THE USE OF BLUE LOCTITE IS REQUIRED ON ALL MOUNTING HARDWARE!

Installation

Left Side Installation

1. Install left side foot peg into frame bracket
2. Connect heim joint into shift rod and reconnect to bell crank
3. Install frame bracket into bike and tighten shift rod security nut
4. For reverse shift see diagram fig. 1
5. Tighten all bolts and nuts (use blue Loctite)

TORQUE VALUES

- M5 = 6FT/LBS
- M6 = 10FT/LBS
- M8 = 25FT/LBS
- M10 = 45FT/LBS

Right Side Installation

1. Install right side foot peg into frame bracket
2. Press rubber bushing into exhaust bracket
3. Install plunger assembly into brake pedal
4. Connect master cylinder into frame bracket
5. Connect frame bracket into bike using supplied bolts
6. Connect exhaust to bracket

Note. Use blue Loctite on all bolts including all rear set and mounting points torque all bolts and recheck after 500 miles.

Note. Before riding your bike make sure rear brake switch is working properly and nothing is impeding free movement.

THIS PRODUCT IS INTENDED TO BE INSTALLED BY A CERTIFIED TECHNICIAN*

FOR OFF ROAD/RACE USE ONLY!



765 right side



765 rear set



765 rear set



765 rear set

THIS PRODUCT IS INTENDED TO BE INSTALLED BY A CERTIFIED TECHNICIAN*

FOR OFF ROAD/RACE USE ONLY!



DRIVEN PERFORMANCE PRODUCTS

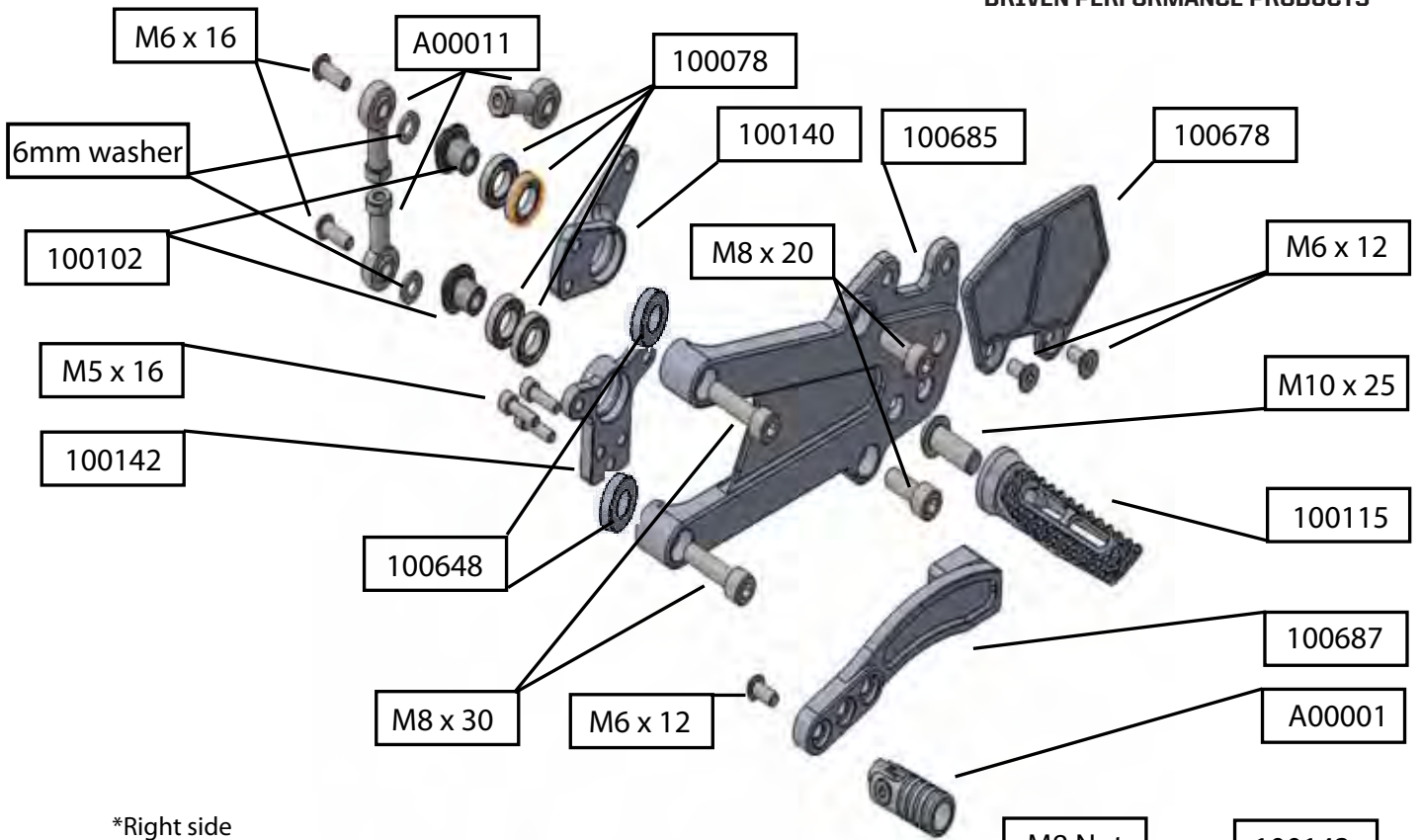

*Right side

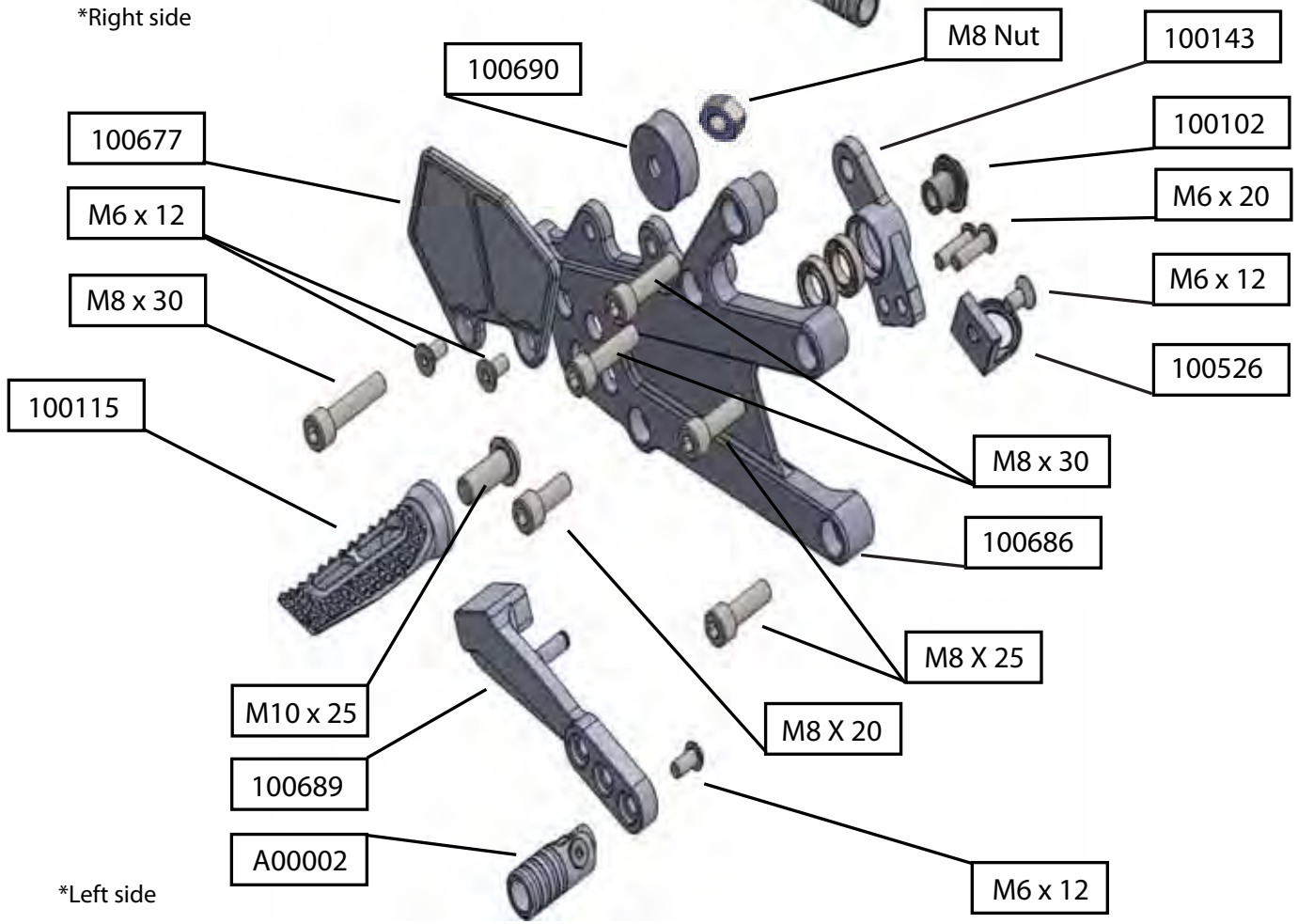

*Left side

THIS PRODUCT IS INTENDED TO BE INSTALLED BY A CERTIFIED TECHNICIAN*

FOR OFF ROAD/RACE USE ONLY!

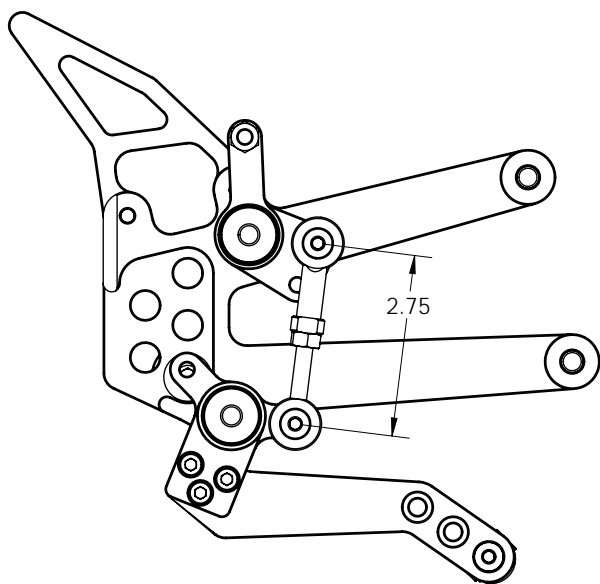

STANDARD SHIFT

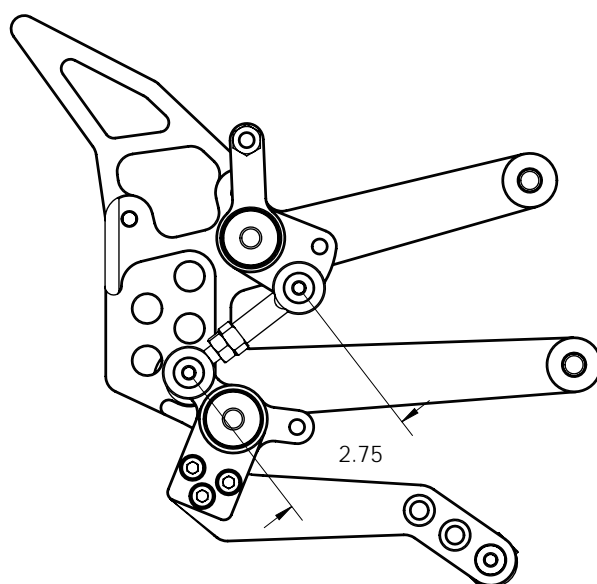

REVERSE SHIFT

THIS PRODUCT IS INTENDED TO BE INSTALLED BY A CERTIFIED TECHNICIAN*