

FOR OFF ROAD/RACE USE ONLY!



Driven TT Rearsets for Kawasaki ZX 636/6R 19-23

Part # DRP-739

Installation Instructions

Removal of Left Side

1. Remove shift pedal
2. Remove shift side frame bracket
3. Remove shift rod from shift pedal

Removal of Right Side

1. Remove heel guard
2. Remove brake side frame bracket side frame bracket
3. Remove pin and master cylinder plunger
4. Remove OEM brake switch and spring (Retain)

Tools Required

- 8mm Open End Wrench
- 5mm Hex Key
- 6mm Hex Key
- 8mm Hex Key
- Needle Nose Pliers
- Screw Driver
- Blue Loctite
- Impact Gun

THE USE OF BLUE LOCTITE IS REQUIRED ON ALL MOUNTING HARDWARE!

Installation

Left Side Installation

1. Install shift rod onto shift pedal
2. Install foot peg into frame bracket in the desired position
3. Install frame bracket into bike
4. Adjust shift lever to desired height
5. Tighten all bolts and nuts (Use blue Loctite)

TORQUE VALUES

- M5 = 6FT/LBS
- M6 = 10FT/LBS
- M8 = 25FT/LBS
- M10 = 45FT/LBS

Note. For reverse shift use part number 100681 (included)

Right Side Installation

1. Install brake plunger into brake pedal using OEM pin and split pin
2. Install foot ped into frame bracket
3. Install brake switch into frame bracket using supplied screws
4. Install master cylinder into fram bracket using supplied screws
5. Install frame bracket into bike using supplied screws

Note. Use blue Loctite on all bolts including all rear set and mouting points torque all bolts and recheck after 500 miles.

Before riding your bike make sure rear brake switch is working properly and nothing is impeding free movement

THIS PRODUCT IS INTENDED TO BE INSTALLED BY A CERTIFIED TECHNICIAN*

FOR OFF ROAD/RACE USE ONLY!



Shift side standard shift



Shift side reverse shift



Brake side



Brake side back side

THIS PRODUCT IS INTENDED TO BE INSTALLED BY A CERTIFIED TECHNICIAN*

FOR OFF ROAD/RACE USE ONLY!



DRIVEN PERFORMANCE PRODUCTS

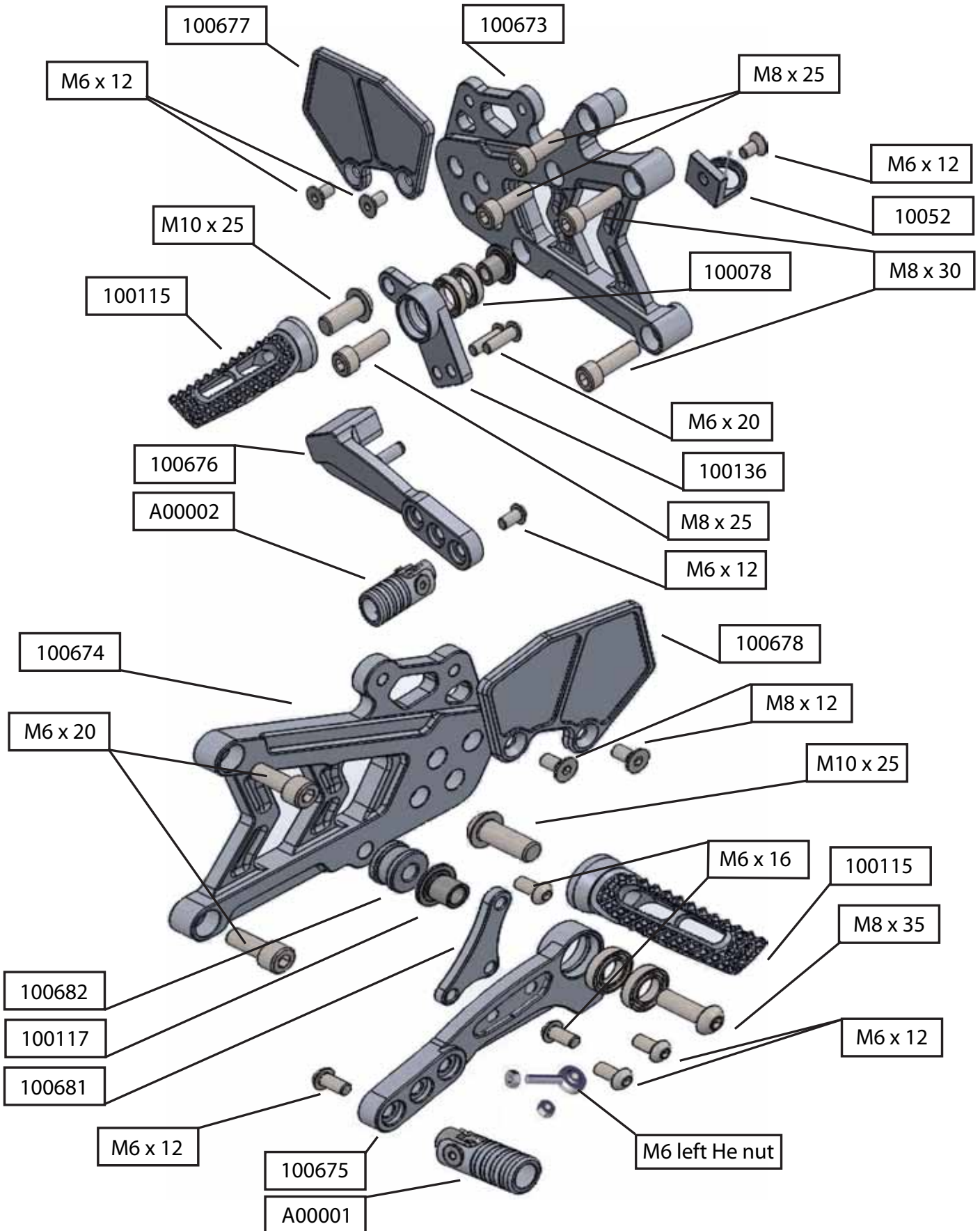

THIS PRODUCT IS INTENDED TO BE INSTALLED BY A CERTIFIED TECHNICIAN*