

FOR OFF ROAD/RACE USE ONLY!



Driven TT Rearsets for 2017 Suzuki SV 650

Part#: DRP-726

INSTALLATION INSTRUCTIONS

Removal:

Left Side

1. Remove shift knuckle from bike.
2. Remove shift rod from shift knuckle.
3. Remove frame plate including stock shift lever from bike.

Brake Side

1. Remove 2 m6 bolts holding heel guard and master cylinder.
2. Remove frame bracket.
3. Remove master cylinder plunger pin from brake pedal
4. Remove rear brake switch and disconnect it from bike.

TOOLS REQUIRED

- 8mm Open End Wrench
- 5mm Hex Key
- 6mm Hex Key
- 8mm Hex Key
- Needle Nose Pliers
- Screw Driver
- Blue Loctite
- Impact Gun

THE USE OF BLUE LOCTITE IS REQUIRED ON ALL MOUNTING HARDWARE!

Installation

NOTE: ALL PIVOT POINTS MUST BE TIGHTENED USING BLUE LOCTITE AND AN IMPACT GUN.

To retain the use of the rear brake light switch a separate M10 X 1.25 aftermarket brake light switch (not included) will need to be used.

Left Side

1. Install foot peg in frame bracket
2. Connect driven shift rod to shift knuckle
3. Install frame bracket onto bike.
4. Adjust shift lever to desired position.

Right Side

1. Install foot peg in frame bracket.
2. Connect master cylinder plunger to brake lever using oem pin and split pin.
3. Install frame bracket to bike
4. Install master cylinder using 2 M6 bolts supplied.
5. Use blue Loctite on all bolts and torque all to required specs.
6. Make sure nothing interfere with proper operation of motorcycle.

Make final adjustments as necessary and re-check all hardware after the first 500 miles of use.

THIS PRODUCT IS INTENDED TO BE INSTALLED BY A CERTIFIED TECHNICIAN*

Left Side

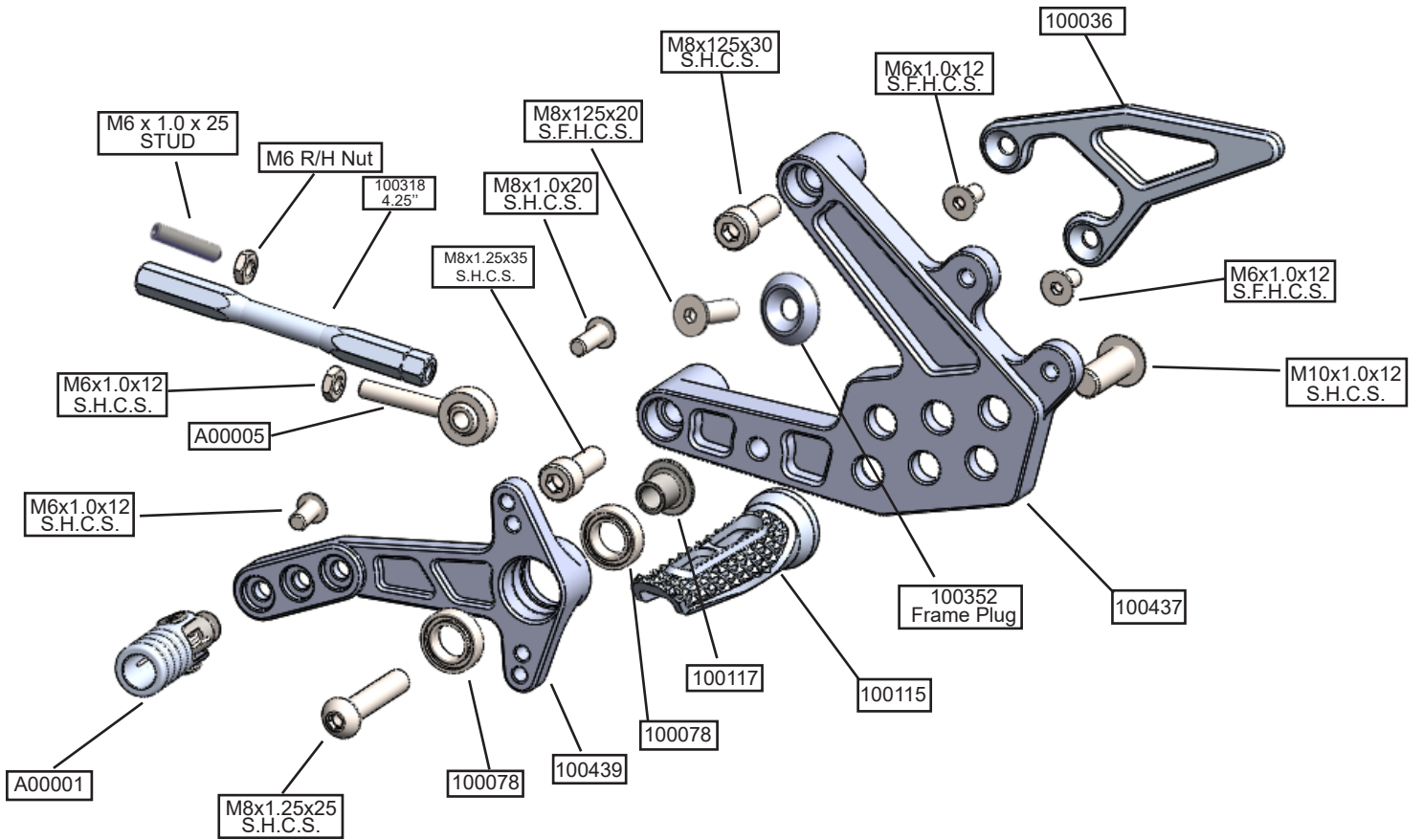

Right Side

