

**FOR OFF ROAD/RACE USE ONLY!**



**Driven TT Rearsets for 15-17 Yamaha R-1/M/S**

**Part#: DRP-717**

## **INSTALLATION INSTRUCTIONS**

### **Removal**

#### **Shifter Side**

1. Remove shift rod from shifter.
2. Remove shift lever.
3. Remove 2 m8 bolts from frame bracket and remove plate from bike.

#### **Brake Side**

1. Remove 2 m6 bolts holding heal guard / master cylinder.
2. Remove master cylinder plunger pin and retain split pin.
3. Remove exhaust bolt from bracket.
4. Remove 2 m8 bolts and remove frame bracket.
5. Remove rear brake switch and disconnect it from bike.

### **TOOLS REQUIRED**

- 8mm Open End Wrench
- 5mm Hex Key
- 6mm Hex Key
- 8mm Hex Key
- Needle Nose Pliers
- Screw Driver
- Blue Loctite
- Impact Gun

**THE USE OF BLUE LOCTITE IS REQUIRED ON ALL MOUNTING HARDWARE!**

### **Installation**

NOTE: ALL PIVOT POINTS MUST BE TIGHTENED USING BLUE LOCTITE AND AN IMPACT GUN.

To retain the use of the rear brake light switch a separate M10 X 1.25 aftermarket brake light switch (not included) will need to be used.

**Special note: Brake pedal is using a captured nut/bushing, an impact gun needs to be used when installing on bike.**

#### **Shifter Side**

1. Install new shift pedal
2. Connect shift rod (left side standard shift right side reverse shift).
3. Install foot peg into left bracket.
4. Install frame bracket using m8 bolts (supplied).
5. Adjust shift pedal with shift rod and tighten safety nut.

#### **Brake Side**

1. Install foot peg in frame bracket.
2. Connect master cylinder plunger to brake lever using oem cotter and pin.
3. Install frame bracket to bike.
4. Install master cylinder using 2 m6 bolts supplied.
5. Connect exhaust to exhaust bracket.
6. Use blue Loctite on all bolts and torque all to required setting.
7. Make sure nothing interfere with proper operation of motorcycle.

### **TORQUE VALUES**

- M5 = 6FT/LBS
- M6 = 10FT/LBS
- M8 = 25FT/LBS
- M10 = 45FT/LBS

**THIS PRODUCT IS INTENDED TO BE INSTALLED BY A CERTIFIED TECHNICIAN\***

**FOR OFF ROAD/RACE USE ONLY!**



(Fig 1.)

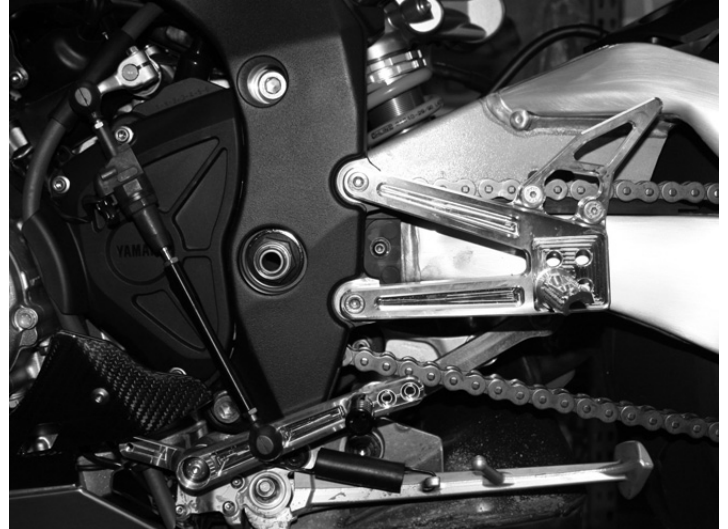

(Fig 2.) Reverse Shift

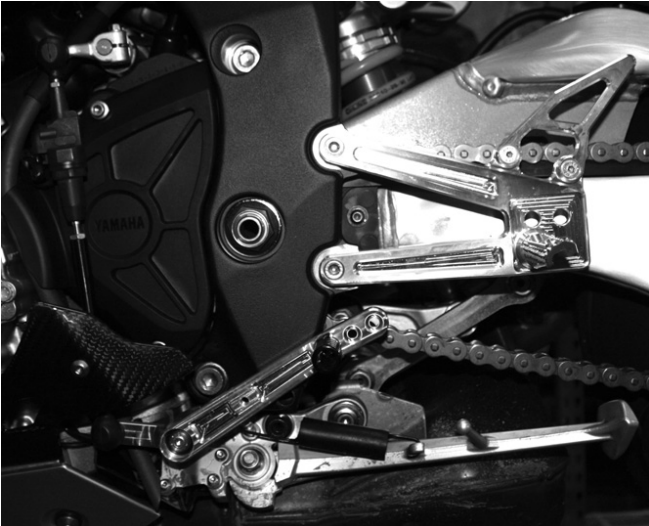

(Fig 3.) Standard Shift

**THIS PRODUCT IS INTENDED TO BE INSTALLED BY A CERTIFIED TECHNICIAN\***

**FOR OFF ROAD/RACE USE ONLY!**



**LEFT SIDE / SHIFTER  
A00030**

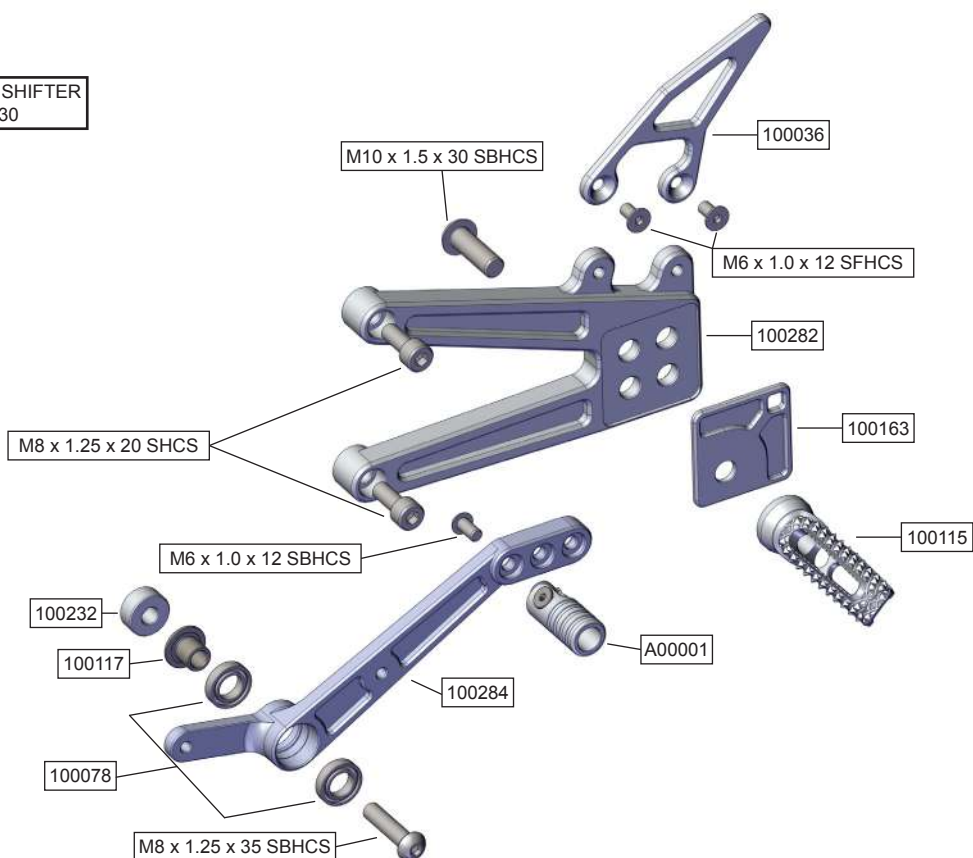

**RIGHT SIDE / BRAKE  
A00031**

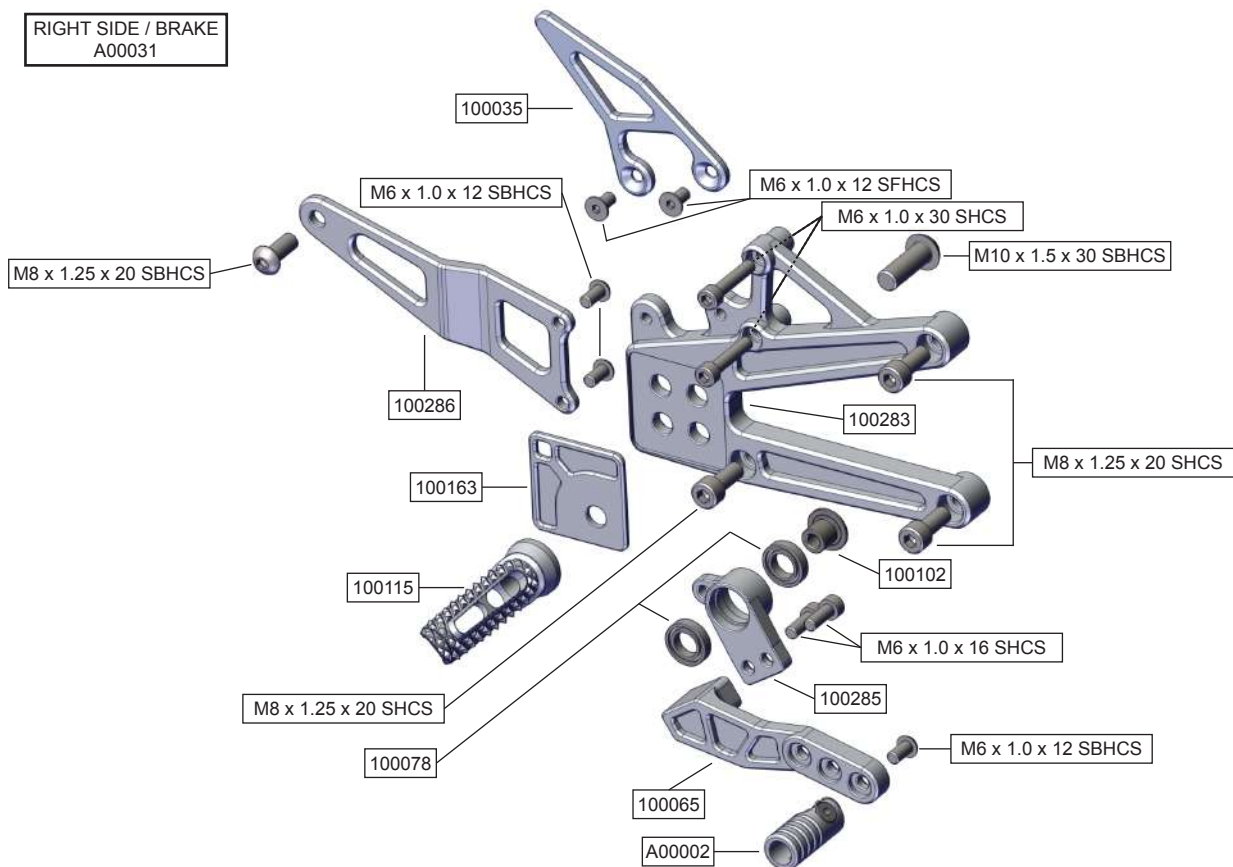

**THIS PRODUCT IS INTENDED TO BE INSTALLED BY A CERTIFIED TECHNICIAN\***