

FOR OFF ROAD/RACE USE ONLY!



Driven TT Rearsets for Honda CBR1000RR / ABS 08-16

Part#: DRP-708

INSTALLATION INSTRUCTIONS

Removal

Shifter Side

1. Remove shift lever.
2. Remove OEM shift rod.
3. Remove lower engine mount nut (see fig 1.)
4. Remove frame bracket.

Brake Side

1. Remove master cylinder bolts and exhaust bolt.
2. Remove frame bracket.
3. Remove master cylinder plunger pin.
4. Remove rear brake switch and disconnect it from bike.

TOOLS REQUIRED

- 8mm Open End Wrench
- 5mm Hex Key
- 6mm Hex Key
- 8mm Hex Key
- Needle Nose Pliers
- Screw Driver
- Blue Loctite
- Impact Gun

THE USE OF BLUE LOCTITE IS REQUIRED ON ALL MOUNTING HARDWARE!

Installation

NOTE: ALL PIVOT POINTS MUST BE TIGHTENED USING BLUE LOCTITE AND AN IMPACT GUN.

To retain the use of the rear brake light switch a separate M10 X 1.25 aftermarket brake light switch (not included) will need to be used.

Shifter Side

1. Install bellcrank boss on engine frame mount, (see fig 1.) (torque to 34ft/lbs and use blue Loctite).
2. Install bell crank (see fig 2.)
3. Install foot peg in desired position.
4. Install frame bracket and connect shift rods, adjust to desired height.

Brake Side

1. Install foot peg in frame bracket.
2. Connect master cylinder plunger to brake lever using OEM cotter pin and pin.
3. Connect master cylinder reservoir to bracket.
4. Connect frame bracket to motorcycle and tighten all bolts.
5. Use blue Loctite on all bolts and torque all to required setting.
6. Make sure nothing interferes with proper operation of motorcycle.
7. For off road use only.

TORQUE VALUES

- M5 = 6FT/LBS
- M6 = 10FT/LBS
- M8 = 25FT/LBS
- M10 = 45FT/LBS

Make final adjustments as necessary and re-check all hardware after the first 500 miles of use.

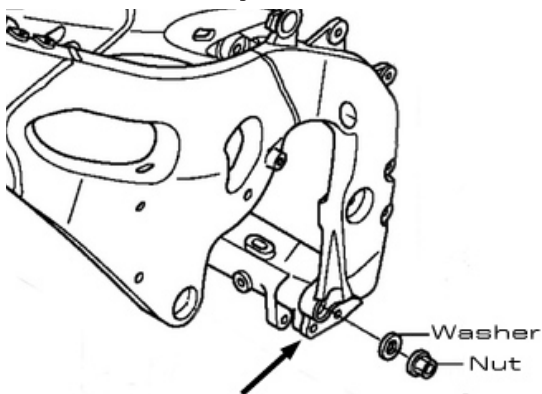

Install Bell Crank Standoff (PN 100158)

(Fig 1.)

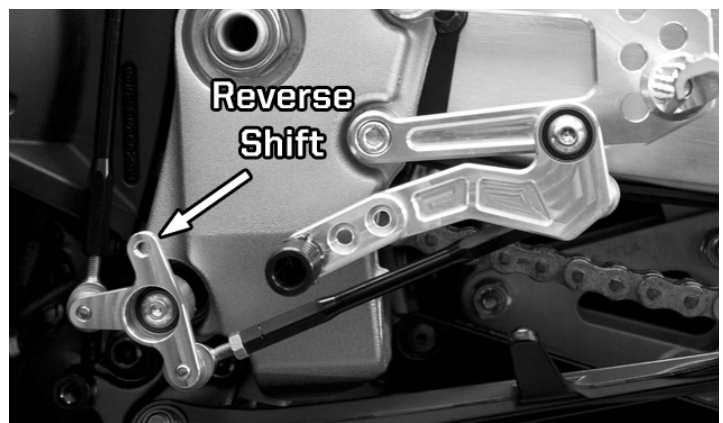

(Fig 2.) Standard Shifting

THIS PRODUCT IS INTENDED TO BE INSTALLED BY A CERTIFIED TECHNICIAN*

FOR OFF ROAD/RACE USE ONLY!



LEFT SIDE / SHIFTER

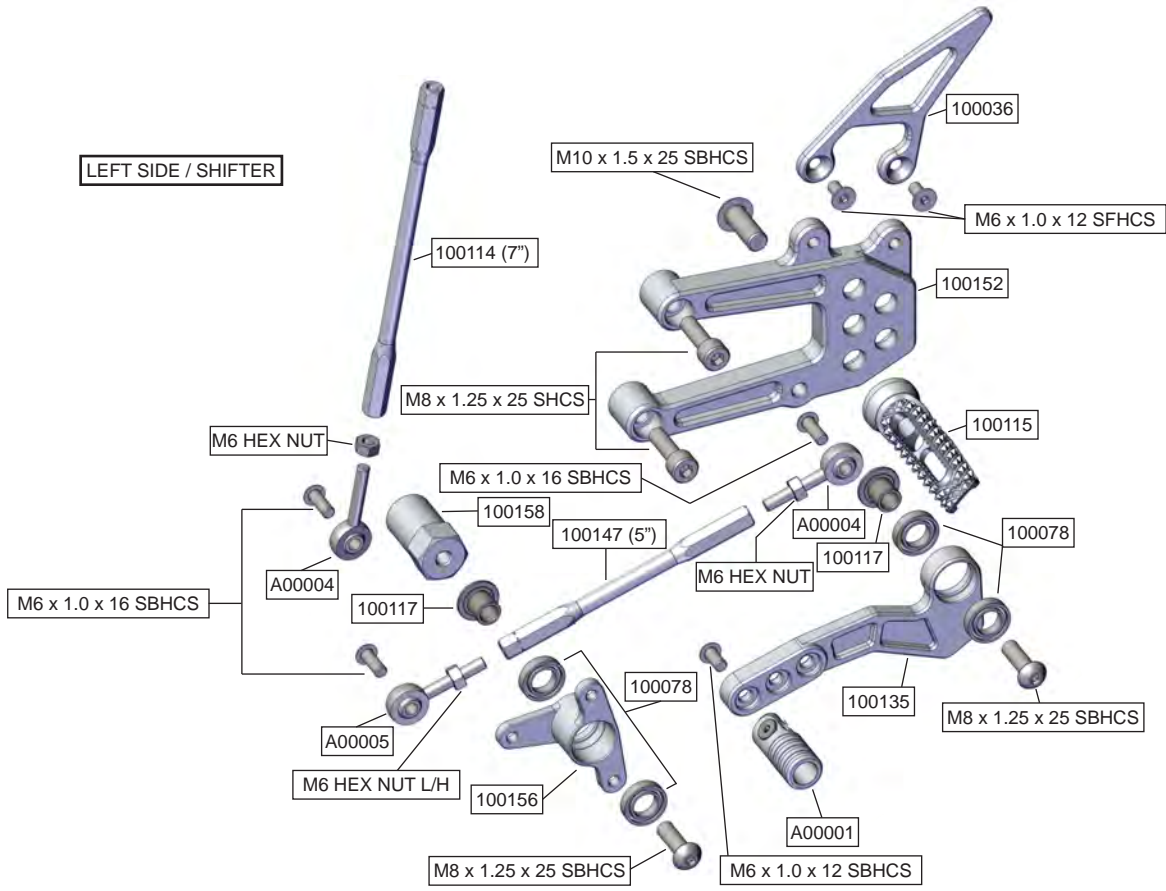

RIGHT SIDE / BRAKE

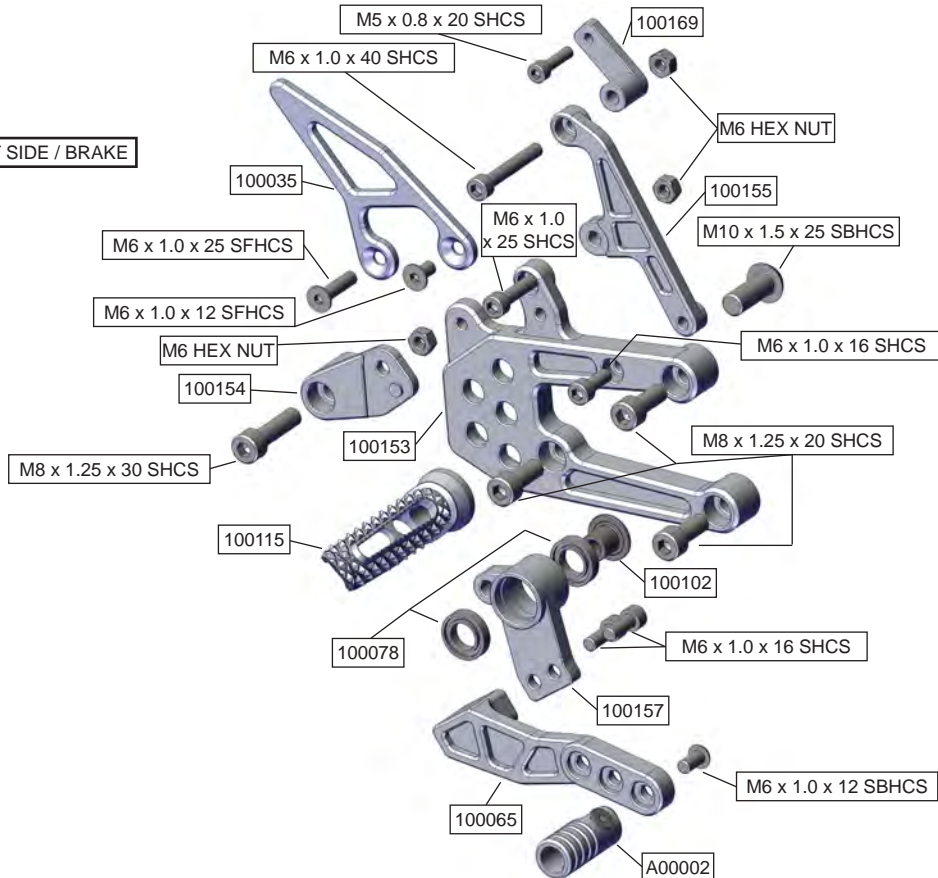

THIS PRODUCT IS INTENDED TO BE INSTALLED BY A CERTIFIED TECHNICIAN*