

**FOR OFF ROAD/RACE USE ONLY!**



**Driven TT Rearsets for Kawasaki ZX6R/636 13-15**

**Part#: DRP-706**

## **INSTALLATION INSTRUCTIONS**

### **Removal**

#### **Shifter Side**

1. Loosen hiem joint at shift knuckle and remove.
2. Remove left side bracket.

#### **Brake Side**

1. Remove two master cylinder screws.
2. Remove Right Side Bracket.
3. Remove plunger, cotter pin and pin.
4. Disconnect rear brake switch.

**THE USE OF BLUE LOCTITE IS REQUIRED ON ALL MOUNTING HARDWARE!**

### **Installation**

#### **Shifter Side**

1. Install foot peg into left side bracket and tighten using blue Loctite.
2. Install left side bracket tighten all bolts and nuts using blue Loctite.
3. Install shift rod and adjust to desired height.

#### **Brake Side**

1. Connect plunger to rear brake paddle using OEM pin and cotter pin.
2. Install master cylinder to bracket using supplied M8 bolts.
3. Install foot peg into left side bracket and tighten using blue Loctite.
4. Install frame bracket to bike tighten bolts using blue Loctite.
5. For reverse shift simply rotate shift knuckle (use m6 stud and nut supplied ) and adjust shift rod to the desired height.
6. Make sure nothing is interfering with operation of motorcycle.
7. For off road use only.

### **TOOLS REQUIRED**

- 8mm Open End Wrench
- 5mm Hex Key
- 6mm Hex Key
- 8mm Hex Key
- Needle Nose Pliers
- Screw Driver
- Blue Loctite
- Impact Gun

***Make final adjustments as necessary and re-check all hardware after the first 500 miles of use.***

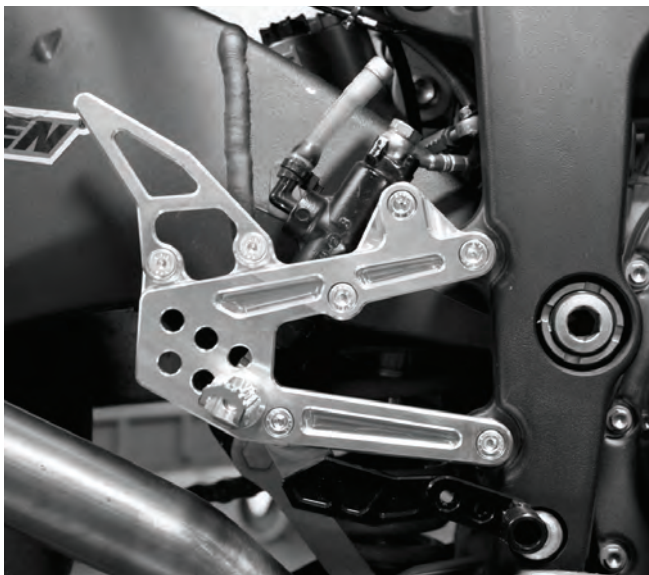

Brake Side

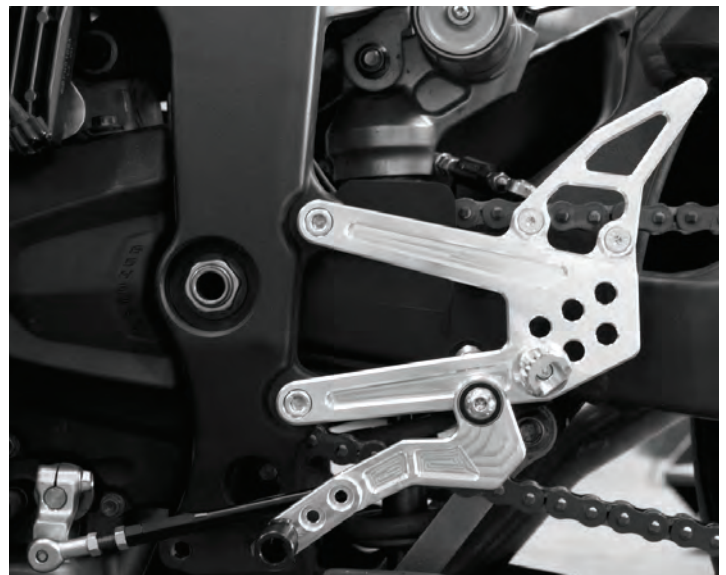

Shifter Side

**THIS PRODUCT IS INTENDED TO BE INSTALLED BY A CERTIFIED TECHNICIAN\***

**FOR OFF ROAD/RACE USE ONLY!**



**Driven TT Rearsets for Kawasaki ZX6R/636 13-15**

**Part#: DRP-706**

**LEFT SIDE / SHIFTER**

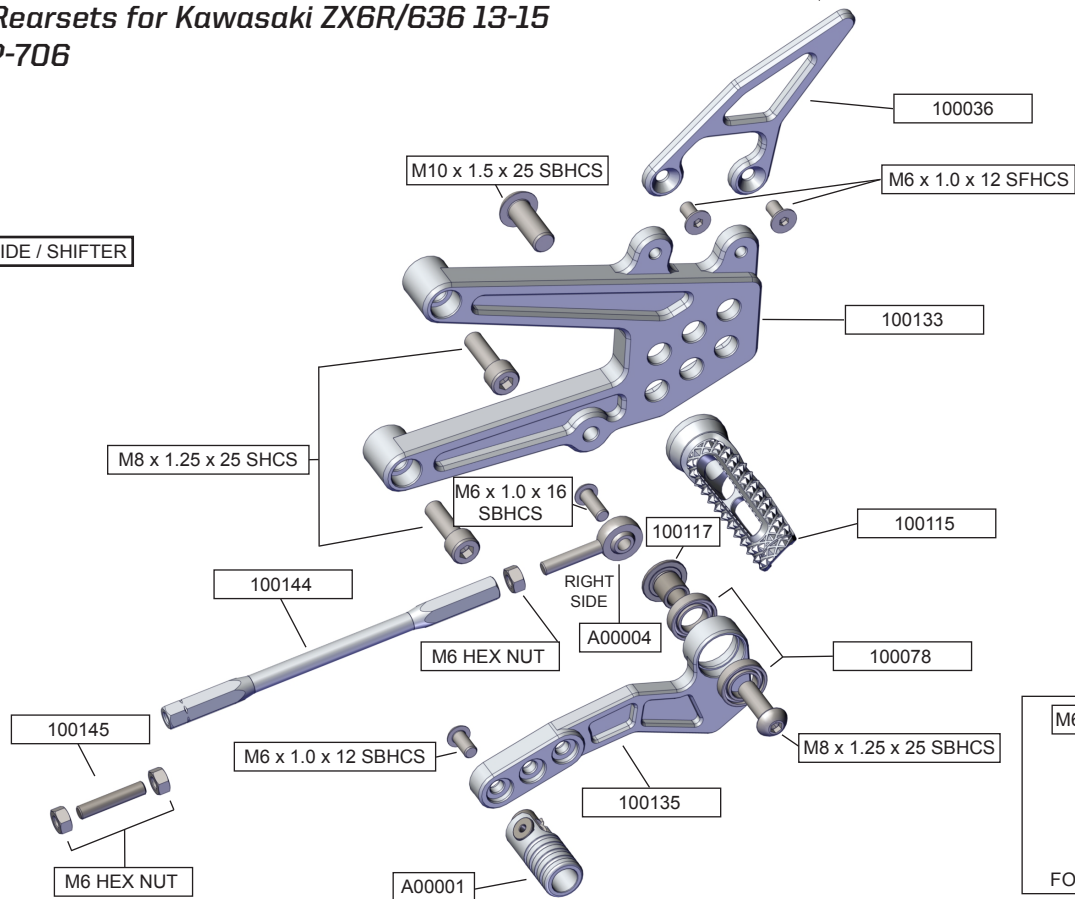

**RIGHT SIDE / BRAKE**

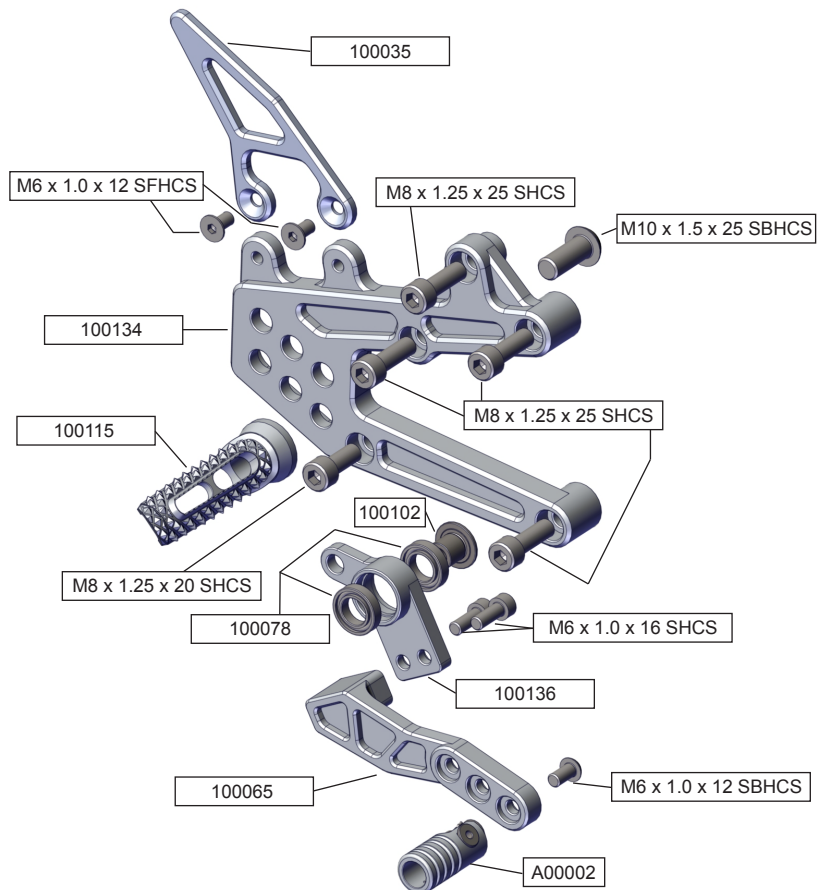

**THIS PRODUCT IS INTENDED TO BE INSTALLED BY A CERTIFIED TECHNICIAN\***