

**FOR OFF ROAD/RACE USE ONLY!**



**Driven TT Rearsets for Yamaha R-6 06-16**

**Part#: DRP-704**

## **INSTALLATION INSTRUCTIONS**

### **Removal**

1. Remove left side (shifter side) frame bracket.
2. Remove shift lever.
3. On the right side (brake side) remove exhaust hanger bolt.
4. Remove right side frame bracket .
5. Remove master cylinder plunger pin (save the cotter pin).
6. Remove master cylinder from frame bracket.

### **TOOLS REQUIRED**

- 8mm Open End Wrench
- 5mm Hex Key
- 6mm Hex Key
- 8mm Hex Key
- Needle Nose Pliers
- Screw Driver
- Blue Loctite
- Impact Gun

**THE USE OF BLUE LOCTITE IS REQUIRED ON ALL MOUNTING HARDWARE!**

### **Installation**

NOTE: ALL PIVOT POINTS MUST BE TIGHTENED USING BLUE LOCTITE AND AN IMPACT GUN.

To retain the use of the rear brake light switch a separate M10 X 1.25 aftermarket brake light switch (not included) will need to be used.

#### **Brake Side**

1. Install master cylinder into left frame bracket.
2. Install master cylinder plunger pin and reuse cotter pin.
3. Install frame bracket to bike.
4. Tighten all bolts (using blue Loctite).

#### **Shifter Side**

1. Install left side foot peg into frame bracket.
2. Install frame bracket assembly onto bike.
3. Install shift pedal and thread shift rod into both heim joints (left and right).
4. Adjust pedal height to desired position by rotating shift rod.
5. Tighten all bolts and nuts (use blue Loctite).

**Note.** If “gp shift pattern” is desired rotate shift knuckle 180 degrees.

### **TORQUE VALUES**

- M5 = 6FT/LBS
- M6 = 10FT/LBS
- M8 = 25FT/LBS
- M10 = 45FT/LBS

**Make final adjustments as necessary and re-check all hardware after the first 500 miles of use.**



Brake Side

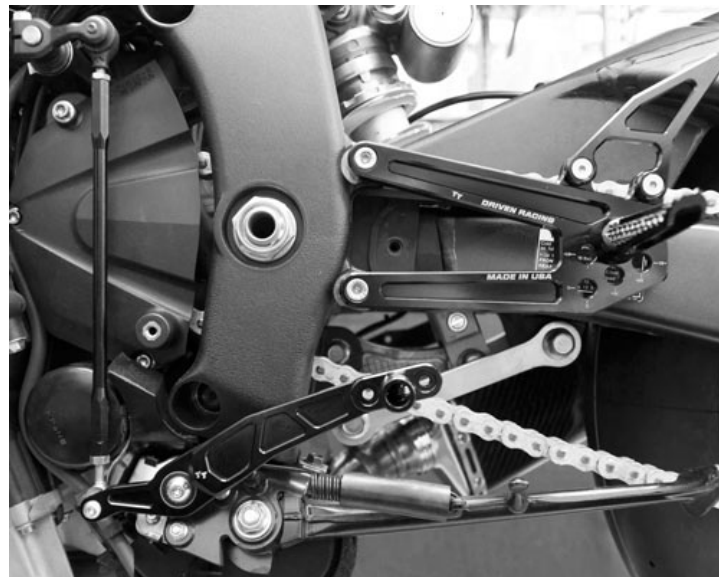

Shifter Side

**THIS PRODUCT IS INTENDED TO BE INSTALLED BY A CERTIFIED TECHNICIAN\***

**FOR OFF ROAD/RACE USE ONLY!**



**Driven TT Rearsets for Yamaha R-6 06-15**

**Part#: DRP-704**

**LEFT SIDE / SHIFTER**

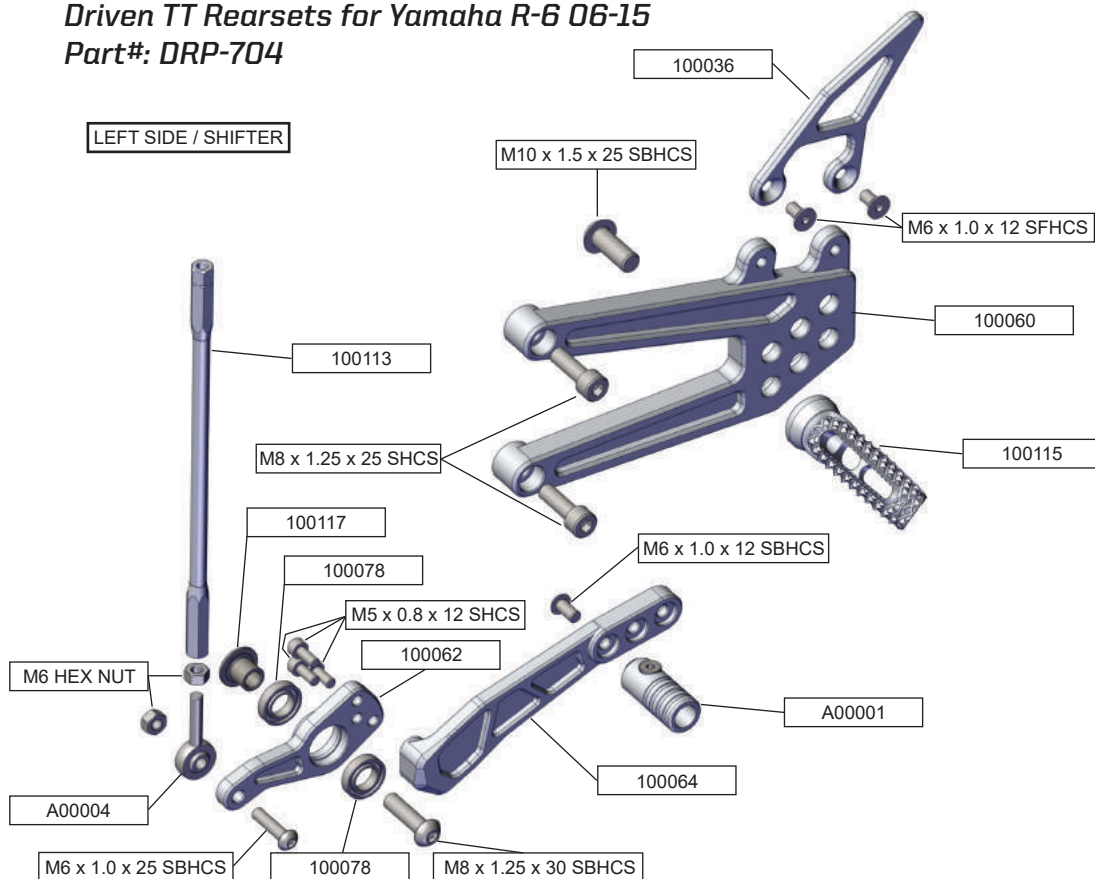

**RIGHT SIDE / BRAKE**

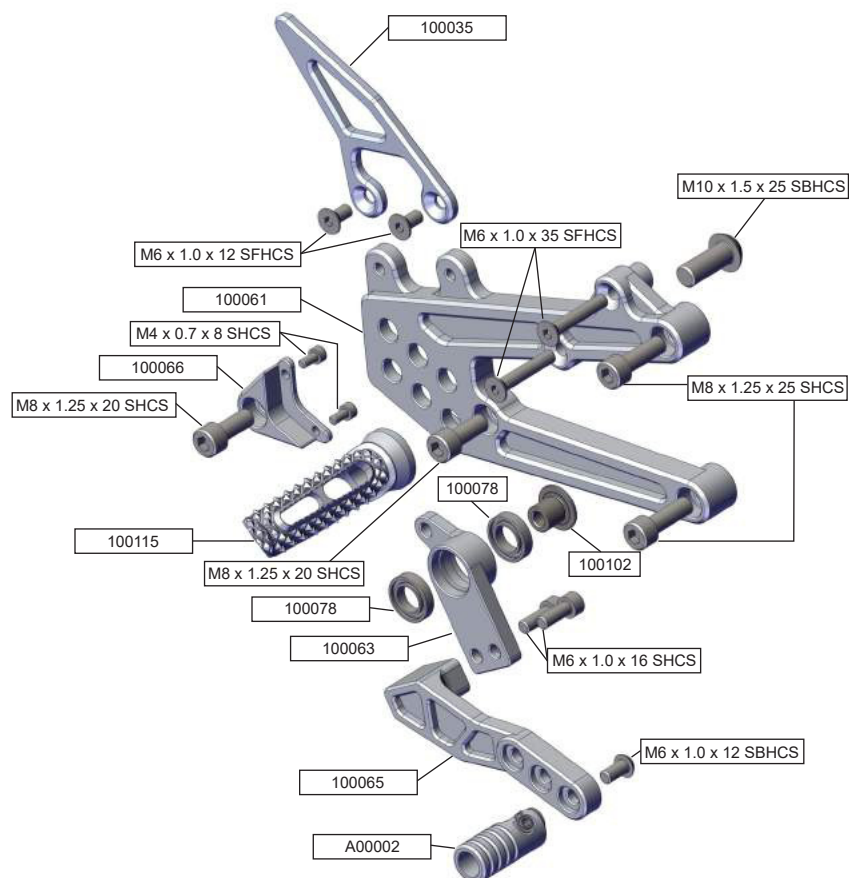

**THIS PRODUCT IS INTENDED TO BE INSTALLED BY A CERTIFIED TECHNICIAN\***