

FOR OFF-ROAD/CLOSED COURSE USE ONLY



**PART#: DRP-703 (DRIVEN RR DUCATI PANIGALE
INSTALLATION INSTRUCTIONS**

BRAKE SIDE

- 1.Remove heel guard and heat shield bracket. Remove master cylinder bracket and retain for re-install.
- 2.Remove plunger and spring and retain for re-install.
- 3.Remove foot rest bracket using a m6 allen key.
- 4.Remove rear brake switch (you will need a pressure switch to activate the rear brake light, not included).
- 5.Using (2) m8 screws install the right side frame bracket (part #: drp-163).
- 6.Install foot peg into rearsset bracket at the desired position and tourqe footpeg screw to 29 ft/lbs.
- 7.Install master cylinder bracket to rearsset bracket and install both plunger and spring to brake pedal using the OEM screw.
- 8.Install brake pedal to rearsset using the supplied m8 screw and an impact wrench.
- 9.Install rearsset to frame bracket using the (2) supplied m8 x 25 screws.

SHIFTER SIDE

- 10.Remove the m6 screw from the shift pedal, then remove the shift pedal from the foot rest assembly.
- 11.Remove foot peg assembly from the frame using an m6 allen key.
- 12.**For installation, you will need to remove both top bell crank and shift pedal from the rearsset bracket and leave the heim joint connected.**
- 13.Install shift rod to the top bell crank (bossed out point) using the supplied m6 cap screw.
- 14.Mount the frame bracket to the frame using the (2) supplied m8 screws.
- 15.Connect the foot peg to rearsset and tourqe to 29 ft/lbs .
- 16.Connect the rearsset to frame bracket using the (2) supplied m8 screws.
- 17.Using an impact gun connect the bell crank and shift pedal to rearsset assembly.

THE USE OF BLUE LOCTITE IS REQUIRED ON ALL MOUNTING HARDWARE!

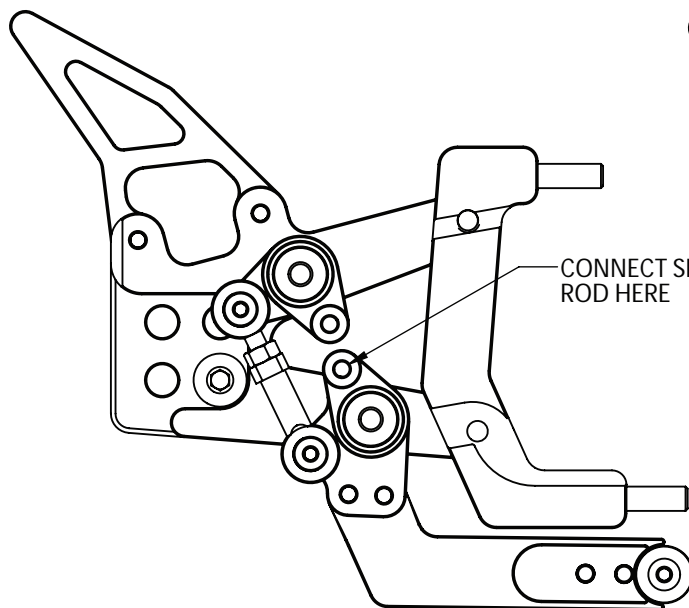

STANDARD SHIFT

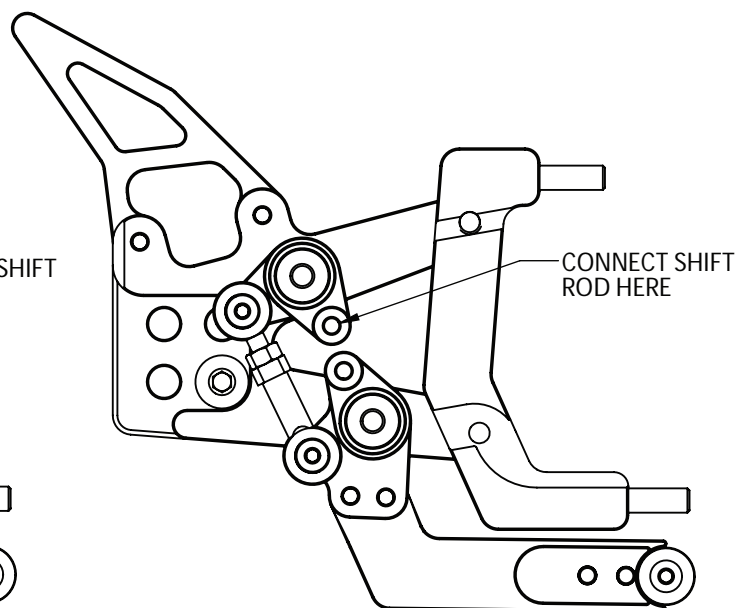

REVERSE SHIFT

THIS PRODUCT MUST BE INSTALLED BY A CERTIFIED MOTORCYCLE TECHNICIAN

