

D-AXIS

DRIVEN PERFORMANCE PRODUCTS
WWW.DRIVENRACING.COM
866-5-DRIVEN



06-12 KAWASAKI ZX-14 REARSETS
PART#: DRP-521



INSTALLATION INSTRUCTIONS



USE BLUE LOCTITE ON ALL MOUNTING BOLTS!



USE ANTI-SEIZE ON THE UNDERHEAD OF ALL COUNTERSUNK BOLTS

1. Remove the stock footrest assemblies from both sides of the bike.
2. Remove the gear change arm at the shift shaft.
3. Bolt the master cylinder to the new right side frame bracket using the supplied bolts.
4. Install left and right frame brackets.
5. Install footpegs onto footrest brackets and adjust eccentric units to desired location, noting index marks.
6. Thread the shift rod onto the new gear shift arm's heim joint (leave jam nuts loose).
7. Bolt the other heim joint to the inside of the shifter.
8. Install the new gear change arm onto the shift shaft and then install and tighten the pinch bolt.
9. Note: Always attempt to maintain a parallel relationship between the gear change arm and the pedal ear.
10. Install left and right footrest bracket assemblies in their desired mounting holes.
11. Adjust shift rod to attain desired shifter/footpeg height.
12. Tighten heim joint jam nuts to finalize shifter height.
13. Adjust clevis and the sliding portion of brake pedal to attain desired brake pedal height, tighten clevis jam nut, and install clevis pin and cotter pin.
14. Be sure to secure any extraneous wires or hoses so they do not become entangled in the rearsset components, swingarm linkage, or wheels.
15. Check torque on all mounting bolts before riding, and again after approximately 20-50 miles to verify.
16. If reverse (GP) shifting is desired, remove bolt from gear shift arm and rotate the arm 180°, then reinstall arm and bolt.

DRIVEN REQUIRES THIS PRODUCT TO BE INSTALLED BY A CERTIFIED TECHNICIAN

TOOLS REQUIRED



8mm hex key
6mm hex key
5mm hex key
4mm hex key
8mm end wrench
10mm end wrench (for shift rod jam nuts)
12mm end wrench (for clevis jam nut)
3/8" end wrench (for new shift rod)
needle-nose pliers (for cotter pin)
blue (#242) Loctite
anti-seize lubricant

TORQUE SPECS AND INFO



M10x1.5 – 55ft-lb (660in-lb)
M8x1.25 – 20ft-lb (240in-lb)
M6x1.0 – 13ft-lb (156in-lb)
M5x0.8 – 5ft-lb (60in-lb)

*OEM height set at the lowest forward mounting hole with the foot peg set at the zero position.

***FOR OFF ROAD / CLOSED COURSE USE ONLY**

D-AXIS

06-12 KAWASAKI ZX-14

PART#: DRP-521

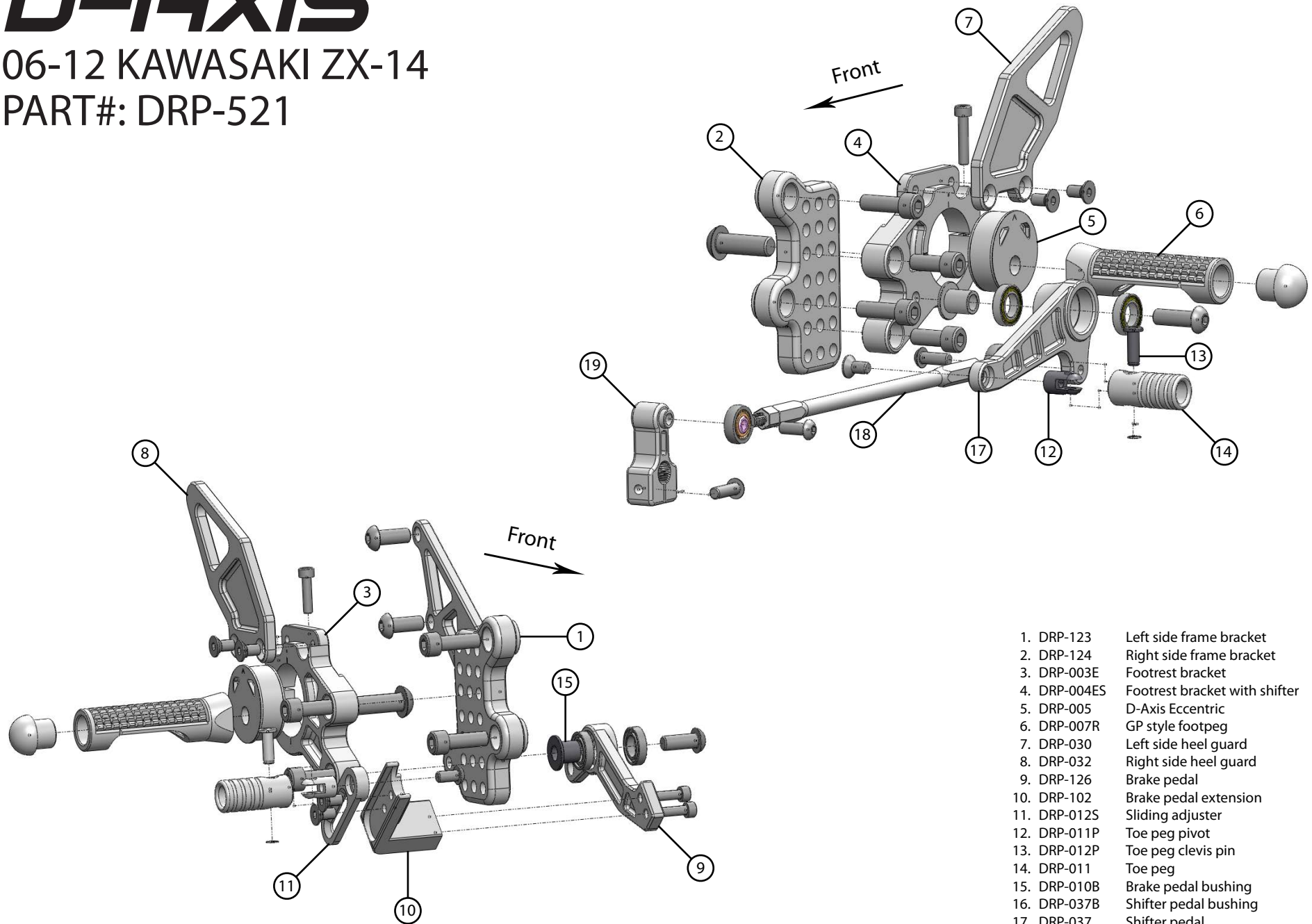

- | | |
|--------------|-------------------------------|
| 1. DRP-123 | Left side frame bracket |
| 2. DRP-124 | Right side frame bracket |
| 3. DRP-003E | Footrest bracket |
| 4. DRP-004ES | Footrest bracket with shifter |
| 5. DRP-005 | D-Axis Eccentric |
| 6. DRP-007R | GP style footpeg |
| 7. DRP-030 | Left side heel guard |
| 8. DRP-032 | Right side heel guard |
| 9. DRP-126 | Brake pedal |
| 10. DRP-102 | Brake pedal extension |
| 11. DRP-012S | Sliding adjuster |
| 12. DRP-011P | Toe peg pivot |
| 13. DRP-012P | Toe peg clevis pin |
| 14. DRP-011 | Toe peg |
| 15. DRP-010B | Brake pedal bushing |
| 16. DRP-037B | Shifter pedal bushing |
| 17. DRP-037 | Shifter pedal |
| 18. DRP-093 | 7 in. shift rod |
| 19. DRP-125 | Gear shift arm |