

D-AXIS

2011 KAWASAKI ZX-10R

PART#: DRP-518

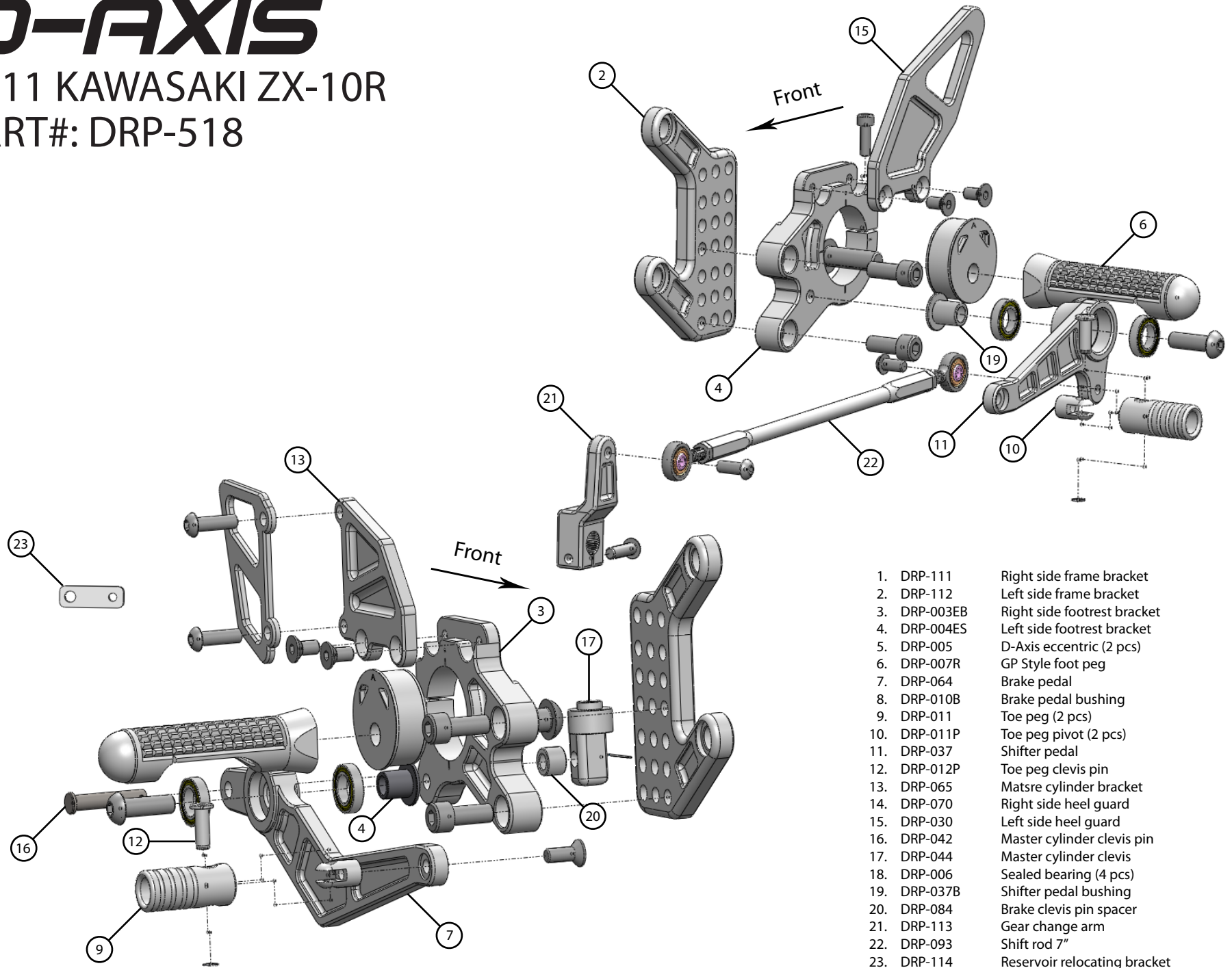

- | | |
|--------------|------------------------------|
| 1. DRP-111 | Right side frame bracket |
| 2. DRP-112 | Left side frame bracket |
| 3. DRP-003EB | Right side footrest bracket |
| 4. DRP-004ES | Left side footrest bracket |
| 5. DRP-005 | D-Axis eccentric (2 pcs) |
| 6. DRP-007R | GP Style foot peg |
| 7. DRP-064 | Brake pedal |
| 8. DRP-010B | Brake pedal bushing |
| 9. DRP-011 | Toe peg (2 pcs) |
| 10. DRP-011P | Toe peg pivot (2 pcs) |
| 11. DRP-037 | Shifter pedal |
| 12. DRP-012P | Toe peg clevis pin |
| 13. DRP-065 | Master cylinder bracket |
| 14. DRP-070 | Right side heel guard |
| 15. DRP-030 | Left side heel guard |
| 16. DRP-042 | Master cylinder clevis pin |
| 17. DRP-044 | Master cylinder clevis |
| 18. DRP-006 | Sealed bearing (4 pcs) |
| 19. DRP-037B | Shifter pedal bushing |
| 20. DRP-084 | Brake clevis pin spacer |
| 21. DRP-113 | Gear change arm |
| 22. DRP-093 | Shift rod 7" |
| 23. DRP-114 | Reservoir relocating bracket |

D-AXIS

DRIVEN PERFORMANCE PRODUCTS
9362 ETON AVE
UNIT B
CHATSWORTH, CA 91311
WWW.DRIVENRACING.COM 866-5-DRIVEN



2011 KAWASAKI ZX-10R REARSETS PART#: DRP-518

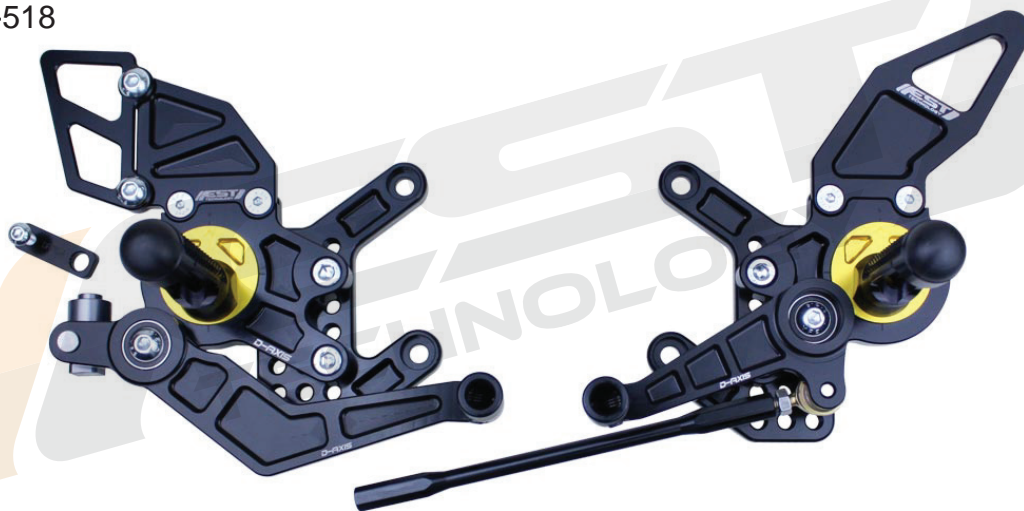

INSTALLATION INSTRUCTIONS



USE BLUE LOCTITE ON ALL MOUNTING BOLTS!



1. Remove the stock footrest assemblies from both sides of the bike.
2. Remove the gear change arm at the shift shaft.
3. Install left and right frame brackets.
4. Install footpegs onto footrest brackets and adjust eccentric units to desired location, noting index marks.
5. Thread the shift rod onto the new gear shift arm's heim joint (leave jam nuts loose)
6. Bolt the other heim joint to the inside of the shifter.
7. Install the new gear change arm onto the shift shaft and then install and tighten the pinch bolt.
Note: Always attempt to maintain a parallel relationship between the gear change arm and the pedal ear.
8. Install left and right footrest bracket assemblies in their desired mounting holes.
9. Adjust shift rod to attain desired shifter/footpeg height.
10. Tighten heim joint jam nuts to finalize shifter height.
11. Replace original master cylinder clevis with new supplied unit and mount master cylinder to master cylinder bracket.
Note: use the supplied M8x1.25x40mm bolt for the upper hole of the master cylinder bracket/heelguard.
12. Slide master cylinder reservoir extension bracket over the rearward protruding portion of the M8x1.25x40mm bolt, and secure with the supplied nut.
13. Attach the rear master cylinder reservoir to the extension bracket with the supplied bolt and washer. (make sure to place the washer under the head of the bolt)
14. Adjust clevis to attain desired brake pedal height, tighten clevis jam nut, and install clevis pin/spacer/washer/cotter pin.
15. Check torque on all mounting bolts before riding, and again after approximately 20-50 miles to verify.

DRIVEN REQUIRES THIS PRODUCT TO BE INSTALLED BY A CERTIFIED TECHNICIAN

TOOLS REQUIRED



8mm hex key
6mm hex key
5mm hex key
4mm hex key
8mm end wrench
10mm end wrench (for shift rod jam nuts)
12mm end wrench (for clevis jam nut)
3/8" end wrench (for new shift rod)
needle-nose pliers (for cotter pin)
blue (#242) Loctite
anti-seize lubricant

TORQUE SPECS AND INFO



M10x1.5 – 55ft-lb (660in-lb)
M8x1.25 – 20ft-lb (240in-lb)
M6x1.0 – 13ft-lb (156in-lb)
M5x0.8 – 5ft-lb (60in-lb)

*OEM height set at the lowest forward mounting hole with the foot peg set at the zero position.

***FOR OFF ROAD / CLOSED COURSE USE ONLY**