

D-AXIS

DRIVEN PERFORMANCE PRODUCTS
9362 ETON AVE
UNIT B
CHATSWORTH, CA 91311
WWW.DRIVENRACING.COM 866-5-DRIVEN



11-12 SUZUKI GSX-R600/750 REARSETS

PART#: DRP-517

BK	<input type="checkbox"/>
BL	<input type="checkbox"/>
GD	<input type="checkbox"/>
RD	<input type="checkbox"/>
SL	<input type="checkbox"/>
TI	<input type="checkbox"/>



INSTALLATION INSTRUCTIONS



USE BLUE LOCTITE ON ALL MOUNTING BOLTS!



1. Remove the stock footrest assemblies from both sides of the bike.
2. Loosen the jam nut on the heim joint on the gear shift arm at the shift shaft.
3. Remove the external snap ring that retains the shifter onto its shaft.
4. Remove stock shifter from the shaft and unscrew the shift rod from the upper heim joint.
5. Thread the new shift rod onto the upper heim joint (*leave jam nuts loose*).
6. Install the new shifter onto the shaft and reinstall the original snap ring.
7. Bolt the lower heim joint to the shifter.
8. Install left and right frame brackets.
9. Install footpeg onto footrest bracket and adjust eccentric unit to desired location, noting index marks.
10. Install left and right footrest bracket assemblies in the desired mounting hole.
11. Adjust sliding portion of the shifter unit to attain desired shifter/footpeg distance.
12. Adjust shift rod to attain desired shifter/footpeg height.
13. Tighten heim joint jam nuts to finalize shifter height.
14. Replace original master cylinder clevis with new one and mount master cylinder to master cylinder bracket.
15. Secure original rear brake lamp switch so it will not become entangled in the rear shock or swingarm.
*To use the rear brake light with rear brake, you must install a 10 x 1.0 brake light pressure switch. Available from any Parts Unlimited dealer.
16. Adjust clevis to attain desired brake pedal height, tighten clevis jam nut, and install clevis pin/spacer/washer/cotter pin.
17. Check torque on all mounting bolts before riding, and again after approximately 20-50 miles to verify.
18. If reverse (GP) shifting is desired, remove bolt from gear shift arm and rotate the arm 180°, then reinstall arm and bolt.

DRIVEN REQUIRES THIS PRODUCT TO BE INSTALLED BY A CERTIFIED TECHNICIAN

TOOLS REQUIRED



6mm hex key
5mm hex key
4mm hex key
8mm end wrench (optional – to remove gear shift arm for reverse shifting)
10mm end wrench (for jam nuts)
12mm end wrench (for clevis jam nut)
3/8" end wrench (for new shift rod)
External snap ring pliers
Needle-nose pliers (for cotter pin)
Loctite (#242) Blue

TORQUE SPECS AND INFO



M10x1.5 – 55ft-lb (660in-lb)
M8x1.25 – 20ft-lb (240in-lb)
M6x1.0 – 13ft-lb (156in-lb)
M5x0.8 – 5ft-lb (60in-lb)

*OEM height set at the lowest forward mounting hole with the foot peg set at the zero position.

***FOR OFF ROAD / CLOSED COURSE USE ONLY**

D-AXIS

11-12 SUZUKI GSX-R600/R750

PART#: DRP-517

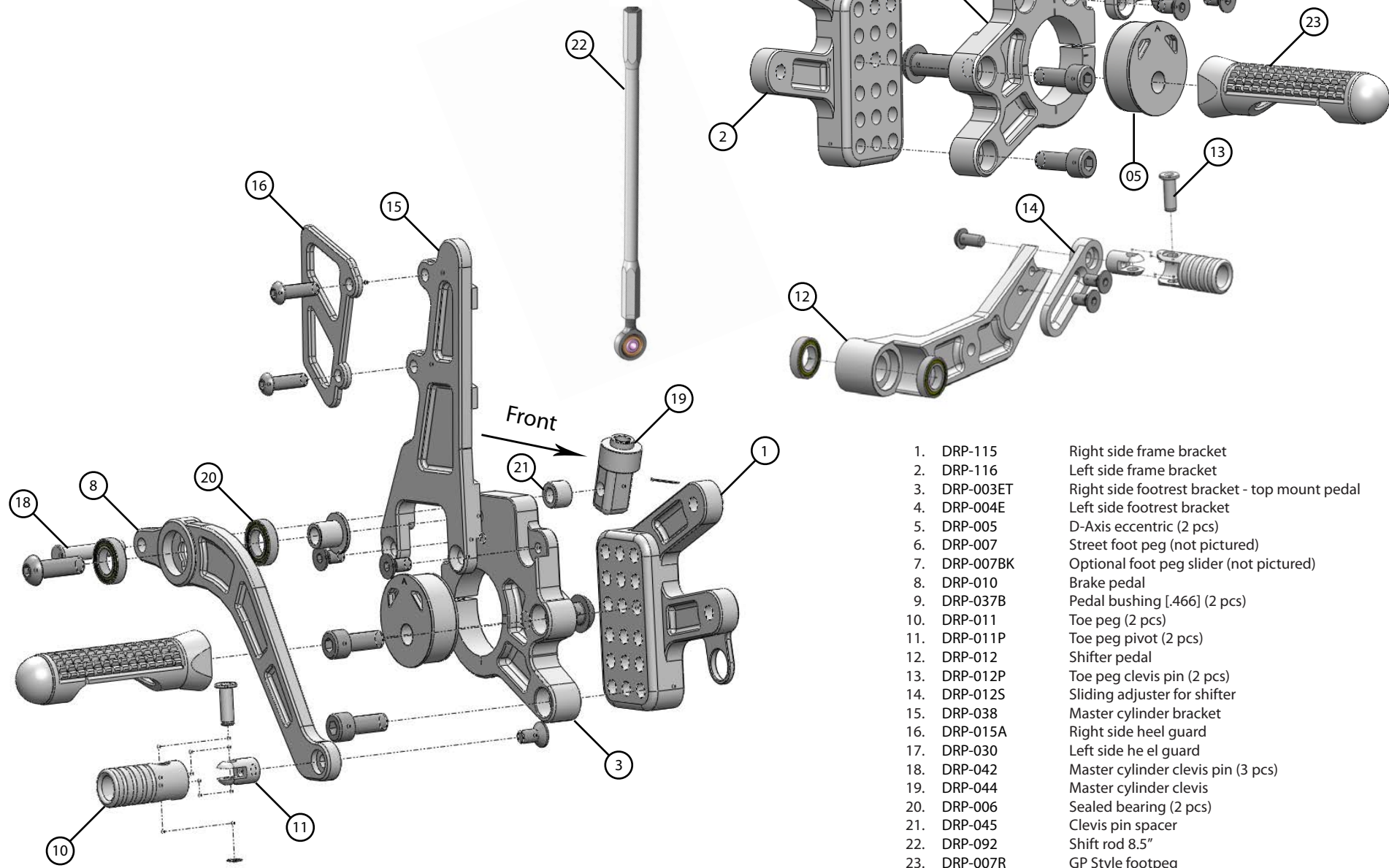

- | | | |
|-----|-----------|---|
| 1. | DRP-115 | Right side frame bracket |
| 2. | DRP-116 | Left side frame bracket |
| 3. | DRP-003ET | Right side footrest bracket - top mount pedal |
| 4. | DRP-004E | Left side footrest bracket |
| 5. | DRP-005 | D-Axis eccentric (2 pcs) |
| 6. | DRP-007 | Street foot peg (not pictured) |
| 7. | DRP-007BK | Optional foot peg slider (not pictured) |
| 8. | DRP-010 | Brake pedal |
| 9. | DRP-037B | Pedal bushing [.466] (2 pcs) |
| 10. | DRP-011 | Toe peg (2 pcs) |
| 11. | DRP-011P | Toe peg pivot (2 pcs) |
| 12. | DRP-012 | Shifter pedal |
| 13. | DRP-012P | Toe peg clevis pin (2 pcs) |
| 14. | DRP-012S | Sliding adjuster for shifter |
| 15. | DRP-038 | Master cylinder bracket |
| 16. | DRP-015A | Right side heel guard |
| 17. | DRP-030 | Left side heel guard |
| 18. | DRP-042 | Master cylinder clevis pin (3 pcs) |
| 19. | DRP-044 | Master cylinder clevis |
| 20. | DRP-006 | Sealed bearing (2 pcs) |
| 21. | DRP-045 | Clevis pin spacer |
| 22. | DRP-092 | Shift rod 8.5" |
| 23. | DRP-007R | GP Style footpeg |