



DRIVEN PERFORMANCE PRODUCTS
CHATSWORTH, CA 91311
WWW.DRIVENRACING.COM 866-5-DRIVEN



05-11 KAWASAKI ZX-6R REAR SETS PART#: DRP-507



INSTALLATION INSTRUCTIONS



USE BLUE LOCTITE ON ALL MOUNTING BOLTS!
USE LOCTITE ANTI-SEIZE ON THE HEADS OF ALL COUNTERSUNK BOLTS



1. Remove the stock footrest assemblies from both sides of the bike.
2. Loosen the jam nut on the heim joint on the gear shift arm at the shift shaft.
3. Unscrew the shift rod from the gear shift arm's heim joint.
4. Install left and right frame brackets.
5. Install footpeg onto footrest bracket and adjust eccentric unit to desired location, noting index marks.
6. Thread the new shift rod onto the gear shift arm's heim joint (*leave jam nuts loose*)
7. Bolt the other heim joint to the inside of the shifter, installing the supplied washer between the two.
8. Install left and right footrest bracket assemblies in the desired mounting hole.
9. Adjust shift rod to attain desired shifter/footpeg height.
10. Tighten heim joint jam nuts to finalize shifter height.
11. Replace original master cylinder clevis with new one and mount master cylinder to master cylinder bracket.
12. Adjust clevis to attain desired brake pedal height, tighten clevis jam nut, and install clevis pin/spacer/washer/cotter pin.
13. Check torque on all mounting bolts before riding, and again after approximately 20-50 miles to verify.
14. If reverse (GP) shifting is desired, remove bolt from gear shift arm and rotate the arm 180°, then reinstall arm and bolt. You will need to install the M6 x 30mm bolt THROUGH the threaded side and affix the included nut in order to secure the gear change arm to the shift shaft.

DRIVEN REQUIRES THIS PRODUCT TO BE INSTALLED BY A CERTIFIED TECHNICIAN

TOOLS REQUIRED



6mm hex key
5mm hex key
4mm hex key
8mm end wrench (*optional – to remove gear shift arm for reverse shifting*)
10mm end wrench (*for jam nuts*)
12mm end wrench (*for clevis jam nut*)
3/8" end wrench (*for new shift rod*)
Needle-nose pliers (*for cotter pin*)
Blue Loctite (#242)
Loctite Anti-Seize Lubricant

TORQUE SPECS AND INFO



M10x1.5 – 55ft-lb (660in-lb)
M8x1.25 – 20ft-lb (240in-lb)
M6x1.0 – 13ft-lb (156in-lb)
M5x0.8 – 5ft-lb (60in-lb)

*OEM height set at the lowest forward mounting hole with the foot peg set at the zero position.

***FOR OFF ROAD / CLOSED COURSE USE ONLY**

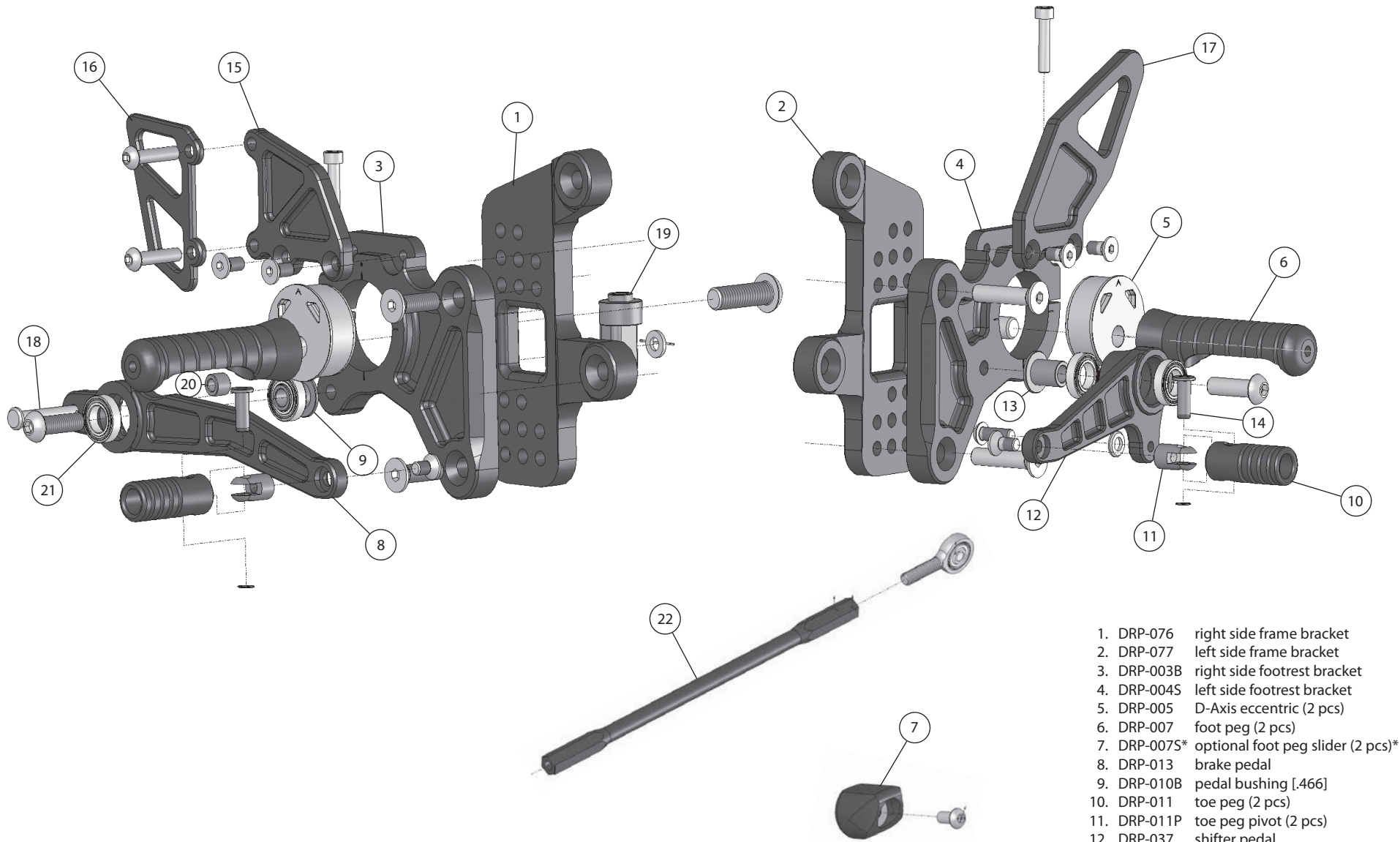

- 1. DRP-076 right side frame bracket
- 2. DRP-077 left side frame bracket
- 3. DRP-003B right side footrest bracket
- 4. DRP-004S left side footrest bracket
- 5. DRP-005 D-Axis eccentric (2 pcs)
- 6. DRP-007 foot peg (2 pcs)
- 7. DRP-007S* optional foot peg slider (2 pcs)*
- 8. DRP-013 brake pedal
- 9. DRP-010B pedal bushing [.466]
- 10. DRP-011 toe peg (2 pcs)
- 11. DRP-011P toe peg pivot (2 pcs)
- 12. DRP-037 shifter pedal
- 13. DRP-037B shifter pedal bushing
- 14. DRP-012P toe peg clevis pin (2 pcs)
- 15. DRP-068 master cylinder bracket
- 16. DRP-070 right side heel guard
- 17. DRP-030 left side heel guard
- 18. DRP-042 master cylinder clevis pin
- 19. DRP-044 master cylinder clevis
- 20. DRP-084 brake clevis pin spacer
- 21. DRP-068 sealed bearing (4 pcs)
- 22. DRP-090 shift rod 6.5 inch
- 23. DRP-084 brake clevis pin spacer short

05-11 KAWASAKI ZX-6R

PART#: DRP-507